

TO: BOARD OF DIRECTORS  
FROM: BRUCE BUEL *BEB*  
DATE: MAY 22, 2009

**AGENDA ITEM  
E-7  
MAY 27, 2009**

REVIEW PROPOSAL TO TRANSFER PROPERTY TO SANTA BARBARA COUNTY

**ITEM**

Establish position on SLO County Public Works proposal to quit claim properties in the Santa Maria River Channel to Santa Barbara County [DEVELOP POSITION AND AUTHORIZE SUBMITTAL]

**BACKGROUND**

Attached is a referral from San Luis Obispo County regarding Public Works Department's proposal to transfer 10 properties currently owned by San Luis Obispo County to Santa Barbara County in part to facilitate Santa Barbara county's effort to rebuild the levee on the South Side of the Santa Maria River Channel. It is interesting to note that not all of the parcels are in the river channel and most have "Extractive Resource Area" (gravel mining) designations. Some of these parcels overlie or are adjacent to the proposed alignment of NCSD's Waterline Intertie Project pipeline.

**FISCAL IMPACT**

Gravel Mining on the properties over or adjacent to NCSD's proposed pipeline could result in a lower pipeline profile resulting in additional construction cost.

**RECOMMENDATION**

Staff recommends that the Board establish an OPPOSE position to the transfer of those properties over/adjacent to NCSD's proposed pipeline and also request that the Extractive Resource Area designation be removed from all of the parcels before they are transferred. Staff further recommends that Director Winn be authorized to speak for NCSD when this item is considered by San Luis Obispo County.

**ATTACHMENTS**

- Referral

t:\documents\board matters\board meetings\board letter 2009\quit claim propsoal.doc



2

SAN LUIS OBISPO COUNTY

# DEPARTMENT OF PLANNING AND BUILDING

VICTOR HOLANDA, AICP  
DIRECTOR

**THIS IS A NEW PROJECT REFERRAL**

DATE: 4/23/09

TO: SCAC

FROM: Brian Pedrotti, South County Team

**PROJECT DESCRIPTION:** SUB2008-0069/ Road Abandonment/County of SLO- Site located along the Santa Maria River Levee. APN: 090-291-037.

Return this letter with your comments attached no later than: 14 days from receipt of this referral. By 5/7/09 please.

**PART 1 - IS THE ATTACHED INFORMATION ADEQUATE TO COMPLETE YOUR REVIEW?**

- YES (Please go on to PART II.)
- NO (Call me ASAP to discuss what else you need. We have only 10 days in which we must obtain comments from outside agencies.)

**PART II - ARE THERE SIGNIFICANT CONCERNS, PROBLEMS OR IMPACTS IN YOUR AREA OF REVIEW?**

- YES (Please describe impacts, along with recommended mitigation measures to reduce the impacts to less-than-significant levels, and attach to this letter)
- NO (Please go on to PART III)

**PART III - INDICATE YOUR RECOMMENDATION FOR FINAL ACTION.**

Please attach any conditions of approval you recommend to be incorporated into the project's approval, or state reasons for recommending denial.

IF YOU HAVE "NO COMMENT," PLEASE SO INDICATE, OR CALL.

---



---



---

\_\_\_\_\_  
Date

\_\_\_\_\_  
Name

\_\_\_\_\_  
Phone



GENERAL APPLIC/

SC/ RSC  
RL

*RL*

File No.: \_\_\_\_\_

APPLICATION TYPE - CHECK ALL THAT APPLY:

*X* Transfer of County Prop

- Public Lot
- Voluntary Merger
- Certificate of Compliance
- Lot Line Adjustment
- Parcel Map
- Tract Map
- Receiving Site
- Sending Site
- Condominium (new or conversion)
- Road Abandonment
- Road Name
- Reversion to Acreage
- Reconsideration
- Address

*Conformity Report*

APPLICANT INFORMATION (check box for contact person assigned to this project)

Landowner Name: Public Works Daytime Phone: 788-2771  
 Mailing Address: Rm 207, Govt Center Zip Code: 93408  
 E-mail Address: \_\_\_\_\_

Applicant Name: Fred Andrews Daytime Phone: 788-2771  
 Mailing Address: Same Zip Code: \_\_\_\_\_  
 E-mail Address: fandrews@co.slo.ca.us

Agent Name: Fred Andrews Daytime Phone: \_\_\_\_\_  
 Mailing Address: SAME Zip Code: \_\_\_\_\_  
 E-mail Address: \_\_\_\_\_

PROPERTY INFORMATION

Total Size of Site: Approx 100 Acres Assessor Parcel Number(s): Attached

Legal Description: \_\_\_\_\_  
Address of the Project (if known): Santa Maria River Levee

Directions to the Site (include gate codes); describe first with name of road providing primary access to the site, then nearest roads, landmarks, etc.: \_\_\_\_\_

Describe current uses, existing structures, and other improvements and vegetation on the property: Levee, Flood Control

PROPOSED PROJECT

Describe the proposed project (including size of all proposed parcels): Attached Memo - proposed Quitclaim Deed from SLO County to Santa Barbara Co FC & WCD

LEGAL DECLARATION

I, the owner of record of this property, have completed this form accurately and declare that all statements herein are true. I do hereby grant official representatives of the County authorization to inspect the subject property.

Property Owner Signature: \_\_\_\_\_ Date: 4-7-09

FOR STAFF USE ONLY:  
Minimum Parcel Size \_\_\_\_\_  Square Feet  Acres  By PSA  By Ordinance

Copy of document found at www.NoNewWipTax.com





# GENERAL PLAN CONFORMITY REPORT APPLICATION FOR ROAD ABANDONMENT

SAN LUIS OBISPO COUNTY DEPARTMENT OF PLANNING AND BUILDING  
976 OSOS STREET • ROOM 200 • SAN LUIS OBISPO • CALIFORNIA 93408 • (805) 781-5600

Promoting the Wise Use of Land • Helping to Build Great Communities

### PROJECT INFORMATION:

Name of Road Requested for Abandonment: N/A see attached Memo

Does the road serve more than your parcel?  Yes  No

If **Yes**, provide the Assessor Parcel Numbers of all parcels that use the road for  
Access: \_\_\_\_\_

Please attach an Assessor Parcel Map(s) showing the road to be abandoned.

~~REASON FOR ROAD ABANDONMENT:~~ General Plan Conformity Report

Please explain your reason for requesting road abandonment:

Public Works is proposing to transfer 10 parcels to Santa Barbara County Flood Control & Water Conservation District - per Govt Code Section 654, planning Agency must provide Conformity Report

### OFFICE USE ONLY:

Date Received: \_\_\_\_\_ By: \_\_\_\_\_ Receipt No.: \_\_\_\_\_  
Road Number: \_\_\_\_\_ Supervisorial District: \_\_\_\_\_  
Planning Approved/Denied Date: \_\_\_\_\_ By: \_\_\_\_\_  
Environmental Determination Complete  C.E.  N.D. Date: \_\_\_\_\_ By: \_\_\_\_\_  
County Engineering Department Approved/Denied Date: \_\_\_\_\_ By: \_\_\_\_\_

Please Indicate Comments/Opinions:  Access Impairment  Circulation  Future Use Issue  
 Sight Distance Problem  Title Problem  Public Use Problem  Environmental Issue  
 Primary Access Issue  Bicycle Use  General Plan Conflict  Utility Reservation  
 Other \_\_\_\_\_

Comments from Public Works: \_\_\_\_\_

Cal Trans Review?  Yes  No Cal Trans Response: \_\_\_\_\_

**SLO COUNTY OWNED PROPERTY  
IN THE  
SANTA MARIA RIVERBED**

<u>APN</u>	<u>SIZE</u>	<u>WHEN ACQ.</u>	<u>WHY ACQ.</u>	<u>ZONE/COMBINING DESIGNATIONS</u>	<u>BK/PAGE</u>
90-291-37 ✓	2.0 ac	12/11/70	Ch. 8 Tax Sale	Rural Lands	<del>1597/195</del>
90-331-09 ✓	2.16 ac	12/11/70	Ch. 8	Agriculture/Flood Hazard	<del>1597/195</del>
90-331-14 ✓	28.77 ac	12/11/70	Ch. 8	Ag/F.H., Extractive Resource Area	<del>1597/195</del>
90-341-22 ✓	4.84 ac	2/11/70	Ch. 8	Ag/F.H., E.R.A.	<del>1597/195</del>
90-341-29	<u>5.70 ac</u>	7/28/77	Ch. 8	Ag/F.H., E.R.A.	<del>1998/515</del>
90-341-32 ✓	<u>44.0 ac</u>	12/11/70	Ch. 8	Commercial Service, Ag/ F.H., E.R.A	1597/195
90-341-43	10.75 ac	12/23/91	Ch. 8	Ag/F.H., E.R.A	3411/267 $\frac{1}{2}$ 1643/ 65
90-401-29 ✓	.71 ac	12/11/70	Ch. 8	Ag/F.H., E.R.A	1597/195
90-401-30*	.90 ac	7/11/77	Ch. 8	Ag/F.H., E.R.A	<del>1998/516</del>
92-231-17 ✓	35.23	12/11/70	Ch. 8	Ag/E.R.A.	<del>1597/195</del>



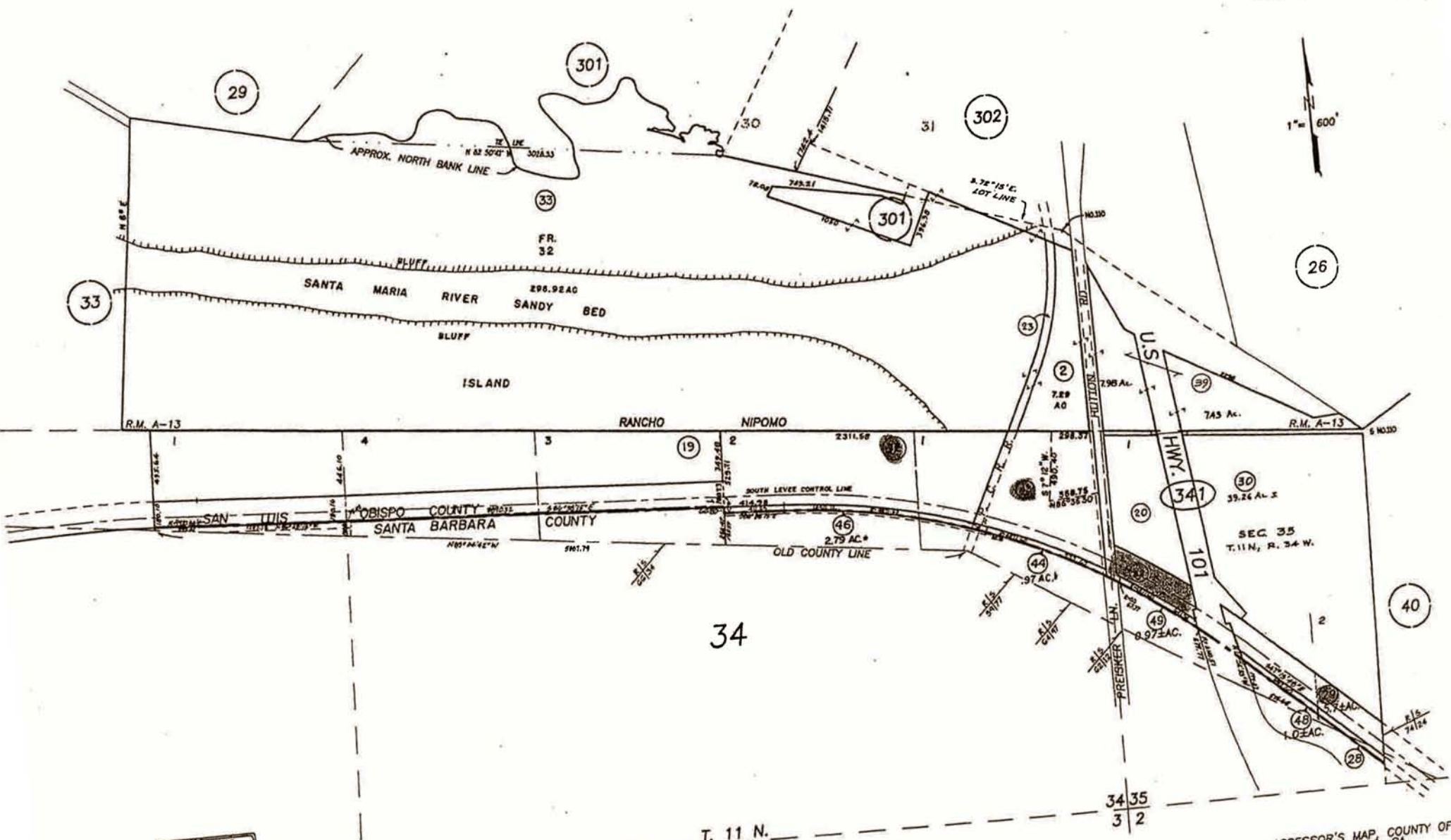

REVISIONS	
TECH	DATE
JAW	08-05-02

33 34  
4 3

300' 0 600' 1200'

JAW 08-16-02 THIS MAP IS PREPARED FOR ASSESSMENT PURPOSES ONLY.

T. 11 N.  
T. 10 N.

34 35  
3 2

T. 11 N.; R. 34 W.; SECTIONS 33 - 35, S.B.B. & N.  
RANCHO NIPOMO, R.M. Bk. A, Pg. 13.

ASSESSOR'S MAP, COUNTY OF  
SAN LUIS OBISPO, CA.  
BOOK 090 PAGE 341

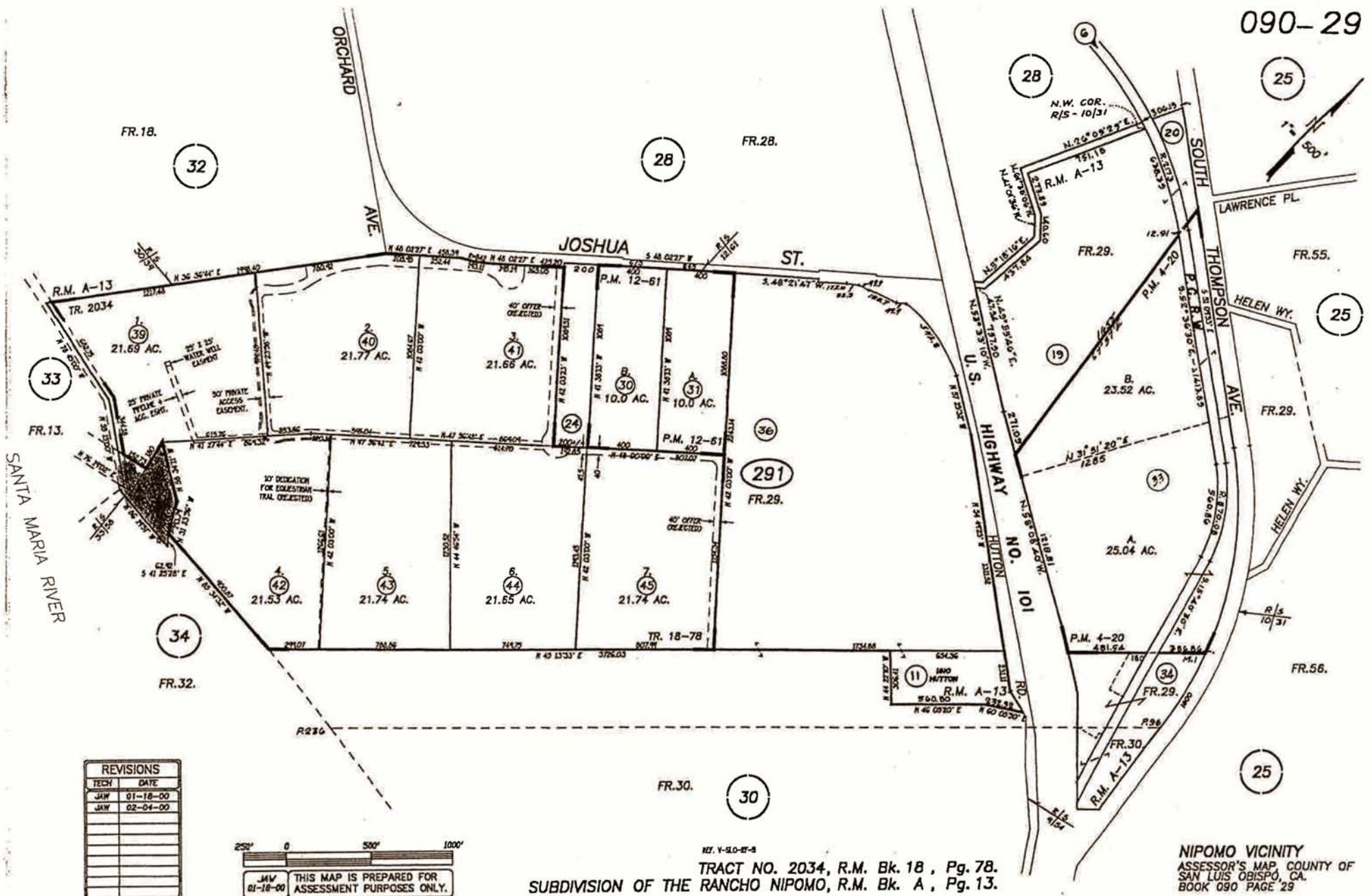

REVISIONS	
TECH	DATE
JAW	01-18-00
JAW	02-04-00

250' 0 500' 1000'

JAW 01-18-00 THIS MAP IS PREPARED FOR ASSESSMENT PURPOSES ONLY.

REF. V-510-B-5  
 TRACT NO. 2034, R.M. Bk. 18 , Pg. 78.  
 SUBDIVISION OF THE RANCHO NIPOMO, R.M. Bk. A , Pg. 13.

NIPOMO VICINITY  
 ASSESSOR'S MAP, COUNTY OF  
 SAN LUIS OBISPO, CA.  
 BOOK 090 PAGE 29



NOTE: THIS MAP-- POLLARD PARTITION, D.B.'S', PG. 382.

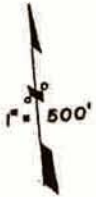

This Map is Prepared For Assessment Purposes Only.

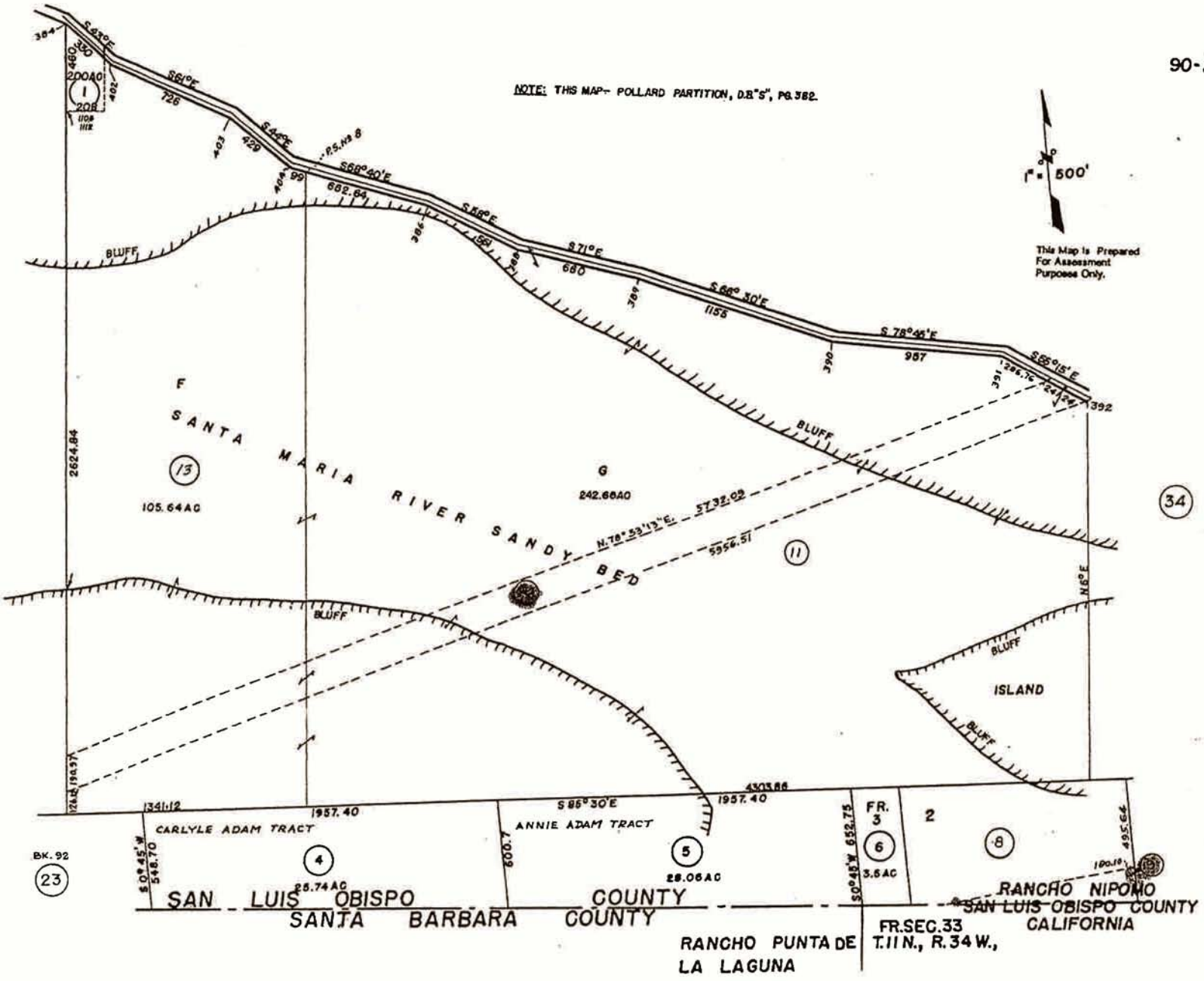

REV. 2/22/65  
B-13-85



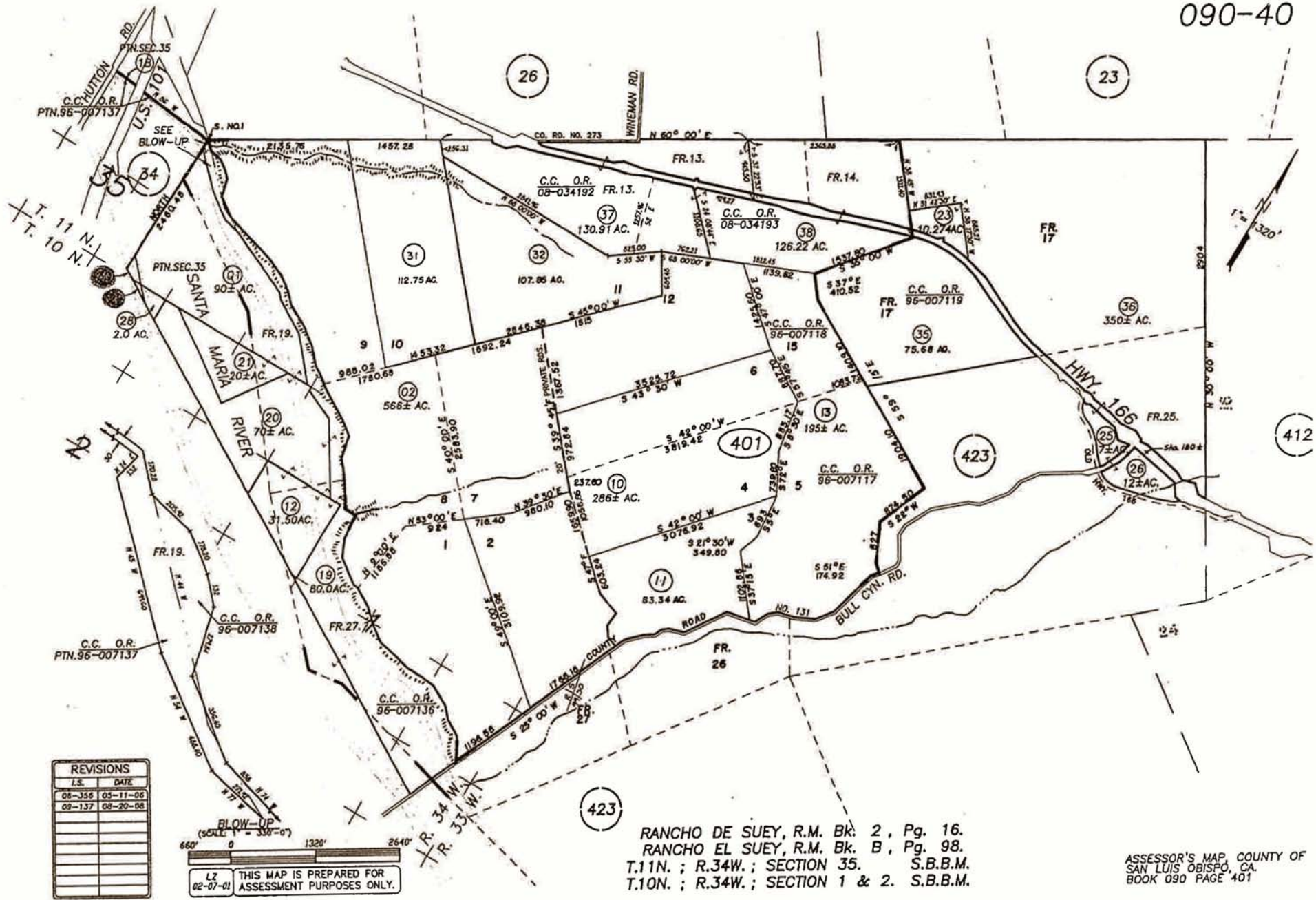

REVISIONS	
L.S.	DATE
08-356	05-11-08
08-137	08-20-08

BLOW-UP  
 (SCALE 1" = 330'-0")  
 660' 0 1320' 2640'

LZ  
 02-07-01 THIS MAP IS PREPARED FOR ASSESSMENT PURPOSES ONLY.

RANCHO DE SUEY, R.M. Bk. 2, Pg. 16.  
 RANCHO EL SUEY, R.M. Bk. B, Pg. 98.  
 T.11N. ; R.34W. ; SECTION 35. S.B.B.M.  
 T.10N. ; R.34W. ; SECTION 1 & 2. S.B.B.M.

ASSESSOR'S MAP, COUNTY OF SAN LUIS OBISPO, CA. BOOK 090 PAGE 401

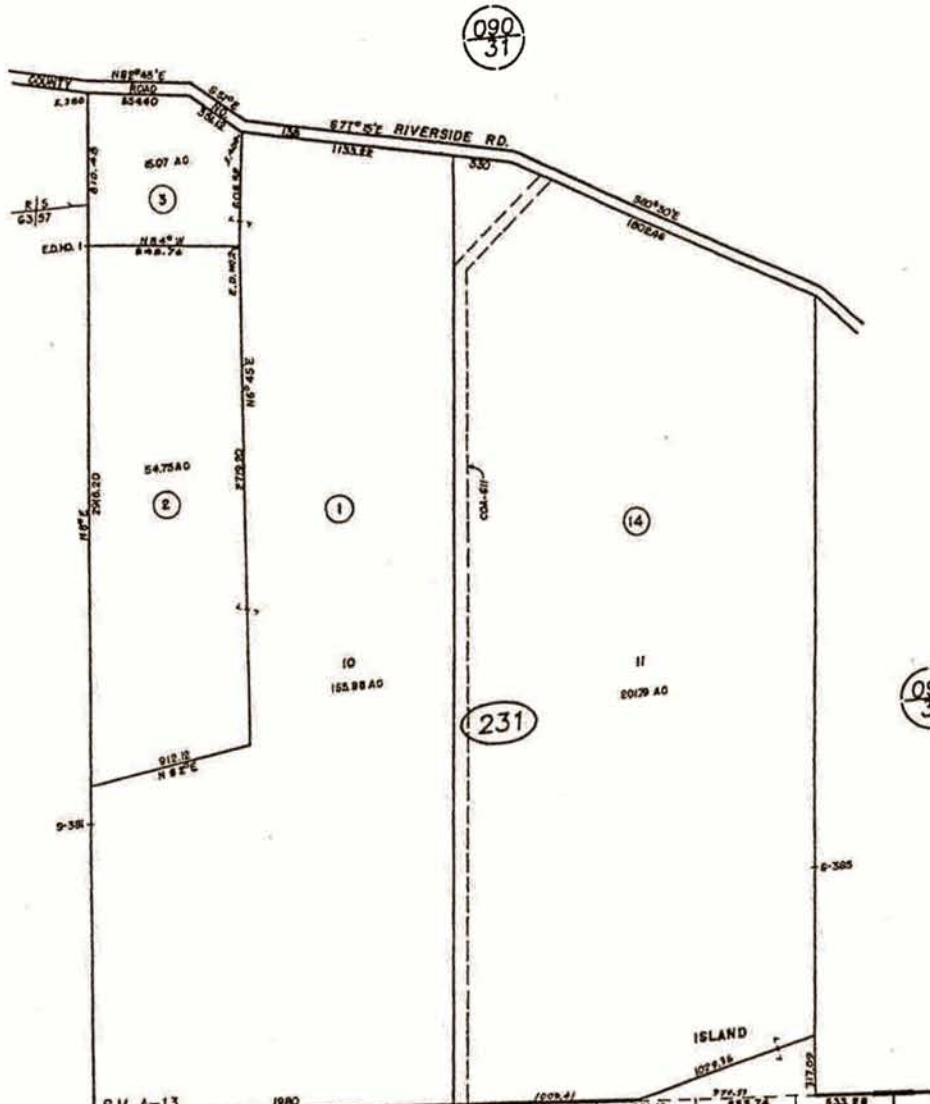

REVISIONS	
TECH	DATE
JAW	02-25-02

330' 0 660' 1320'

JAW  
02-25-02

THIS MAP IS PREPARED FOR  
ASSESSMENT PURPOSES ONLY.

37

R.M. A-13

RHO. PUNTA DE LA LAGUNA

SANTA BARBARA COUNTY

LEVEE TRAVERSE

LINE 15 COUNTY LINE

14 13 12

SUBDIVISION OF LOT 2, RANCHO PUNTA DE LA LAGUNA; RECORDED IN SANTA BARBARA COUNTY.  
H.C. WARD'S SUBDIVISION OF THE RANCHO NIPOMO, R.M. Bk. A Pg. 13.

ASSESSOR'S MAP, COUNTY OF  
SAN LUIS OBISPO, CA.  
BOOK 092 PAGE 23



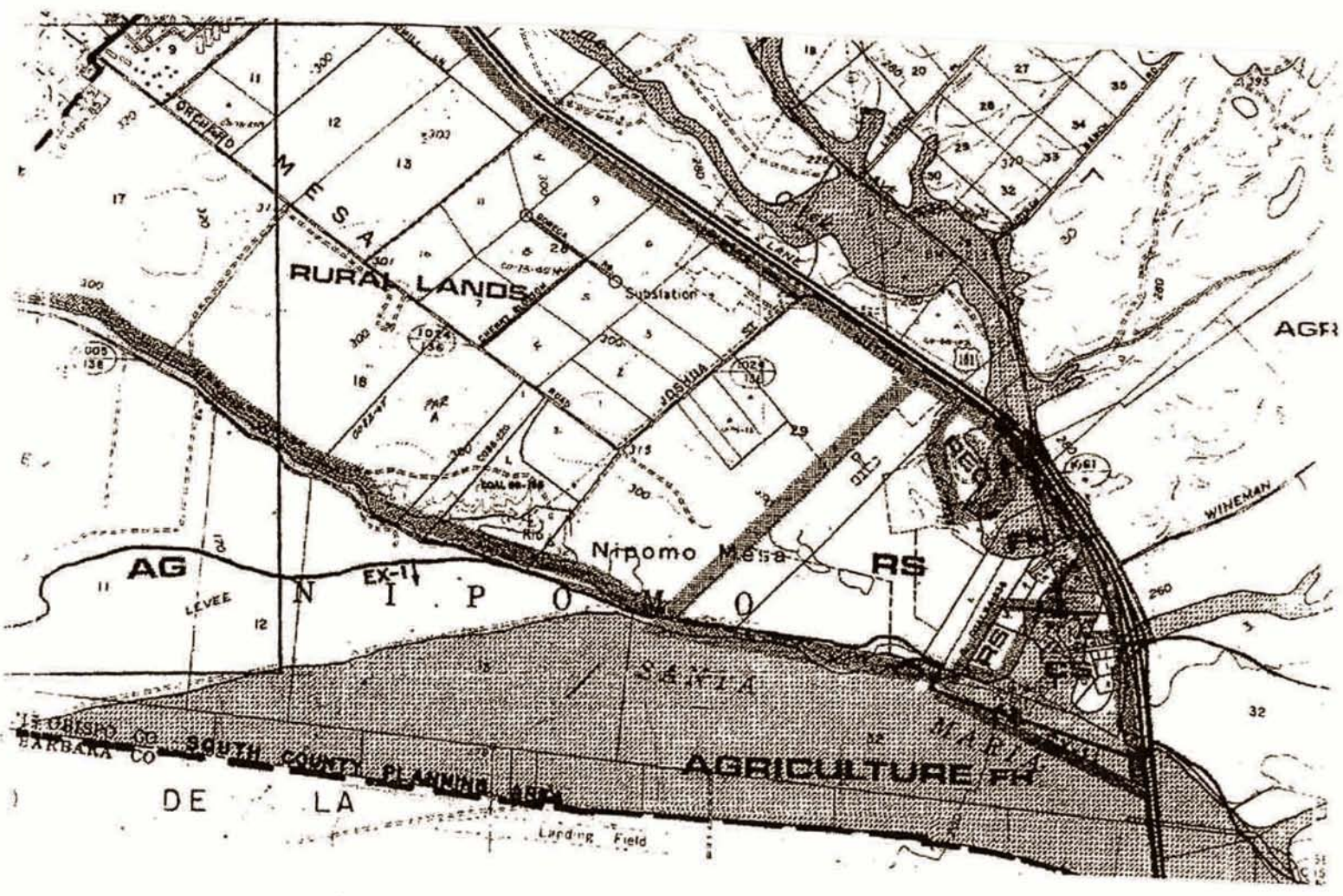









# Parcel Summary Report For Parcel # 090-291-037

4/16/2009  
12:32:07PM

## San Luis Obispo County Department of Planning and Building

County Government Center

San Luis Obispo, California 93408

Telephone: (805) 781-5600

### Address Information

<u>Status</u>	<u>Address</u>
P	00000 RIVERSIDE RD RSC

### Lot Information:

Community: RSC

Planning Area: SC

<u>Lot Type</u>	<u>Tract / Twnshp</u>	<u>Block / Range</u>	<u>Section</u>	<u>Lot</u>	<u>Land Use Elements</u>	<u>Lot Flags</u>	<u>Misc</u>
P	090291	037	0001	U	RL	MB / DC	

### People Information

<u>Role</u>	<u>Name and Address</u>	<u>Phone Numbers and Contact info</u>	<u>Notes</u>
OWN	SLO CO OF		

### Parcel Information

<u>Status</u>	<u>Description</u>	<u>Notes</u>
Active	ZAC VACANT	