



March 3, 2004

John Scardino  
Woodlands Ventures, LLC  
31200 Via Colinas, Suite 200  
Westlake Village, California 91362

**SUBJECT: Semi-Annual Ground Water Monitoring Report for Onsite and Offsite Wells at The Woodlands Development, Nipomo Mesa, San Luis Obispo County, California**

Dear Mr. Scardino:

This report documents the monitoring of water levels at eight wells in the vicinity of The Woodlands project and the six wells on The Woodlands property. This work has been performed as part of the mitigation program resulting from the project environmental impact report. Cleath & Associates has been monitoring water levels on a monthly basis on the Woodlands site since March 1999. Well locations are shown on Figure 1.

In order to obtain an accurate reference point for water level measurements, each of the onsite and offsite wells were surveyed by a licensed surveyor with John L. Wallace & Associates during September 2003. The survey determined the location and the elevation of the top of well casing for each well.

### **Onsite Wells**

Four of the onsite wells were constructed as production wells for the project, with the Highway 1 Monitoring well and the Flintcote well utilized as monitoring wells only. The Flintcote well was drilled in 1944, and the five Woodlands project wells were drilled in 1993 and 1994.

Ground water elevations for the onsite wells are shown on Figure 2. Seasonal water level fluctuations range between approximately 25 and 35 feet in the six onsite wells. The slightly declining average water levels indicated in the hydrograph is a result of changing climatic conditions in the area during the monitoring period. The slightly higher average water levels measured during the earlier months of the monitoring period reflect the higher than normal precipitation of the mid and late 1990s. Average to below average annual precipitation has occurred in the years since the monitoring program began.

A pump was installed in the Homestead well in April 2003, at the beginning of the tree clearing activity at the site. The well has been pumped daily except during rainy periods and Sundays, to fill water trucks. There is no flow meter at the pump, but according to the truck drivers, approximately 80,000 gallons per day are being pumped. Based on an estimated 237 days of pumping, from April 1 to February 15, approximately 58 acre-feet have been pumped during that period. Most of the water levels measured during the current monitoring period from September through February, reflect water levels that were

**Figure 2**  
**Water Levels: February 1999 - February 2004**  
**The Woodlands On-Site Wells**

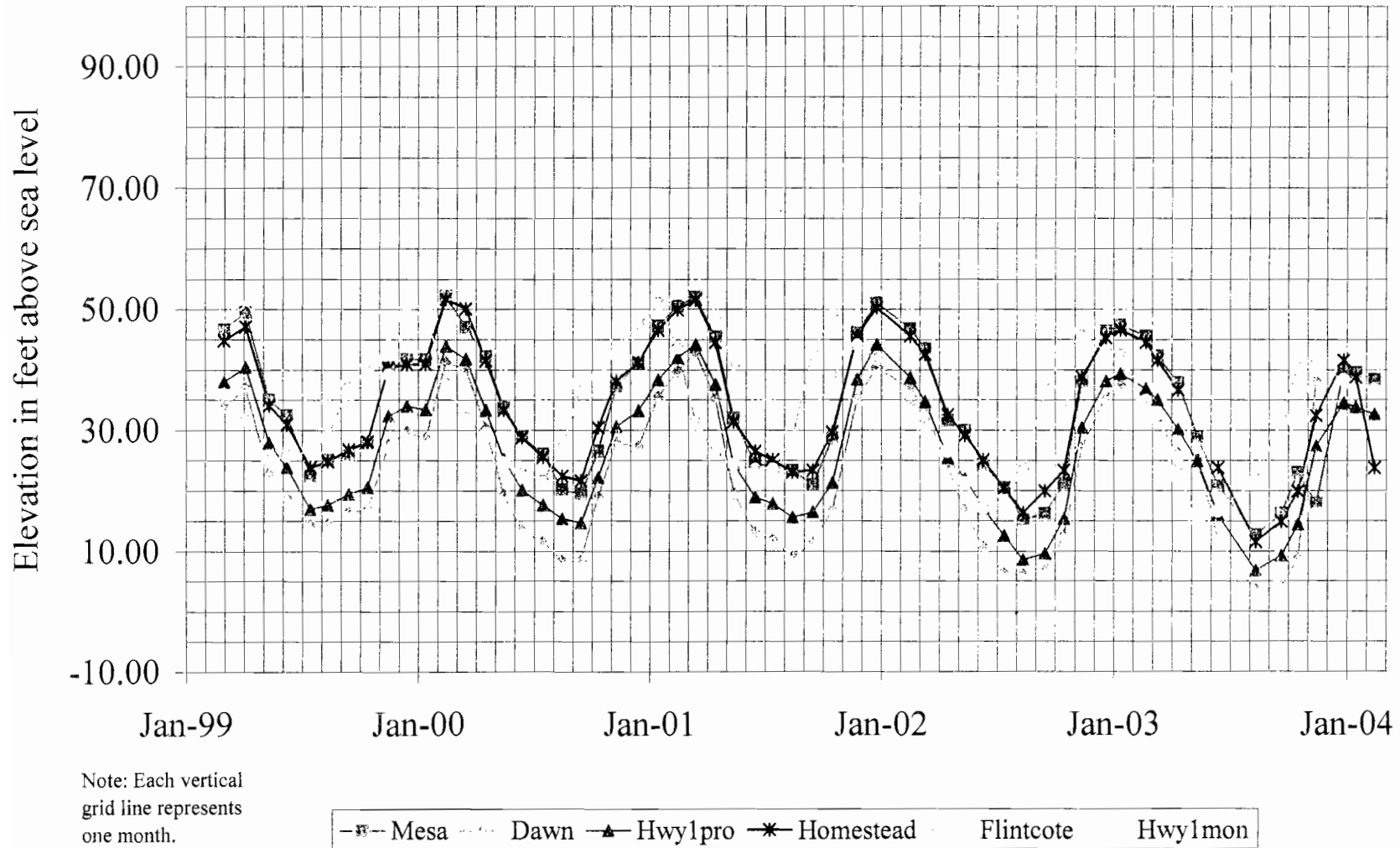



rising following pump shut off. The pump had been shut off for several days prior to the water level measurement on December 31, resulting in a more representative static water level.

## **Offsite Wells**

An additional offsite well (Casano) was included in the monitoring program in January 2004. The Casano well has been monitored by the San Luis Obispo County Public Works Department in March and October of every year since 1973. It is used for domestic purposes and is located northwest of the Woodlands property (Figure 1). The offsite Fisher domestic well was monitored from October 2000 to February 2001 and was dropped from the program because of down-hole obstructions. The Moreno and Foster wells are currently used as domestic supply wells to single-family homes and are pumped on a regular basis. The Anderson well had been used both for domestic and irrigation purposes, however, it has been inactive since monitoring began. The Pudwill-West well is used for domestic and irrigation supply, and has been pumped on a regular basis since the beginning of the current monitoring period. The Craig well had been equipped with a temporary pump, however, the pump was removed in December 2003. The Guerrero well is equipped with a pump but is currently inactive. The eight offsite wells are listed in Table 1.

Depths to ground water for the offsite wells are shown on Figure 3. Ground water elevations at the Casano well were based on a reference point determined by the County of San Luis Obispo. John L. Wallace & Associates will resurvey the well using the same datum as used for the other offsite and onsite wells. The Fisher well reference point elevation was estimated from the USGS topographic map. Seasonal changes in depths to water have been approximately 15 and 18 feet in the Anderson and Moreno wells respectively. The Craig and Pudwill-West wells have been monitored during only one cycle of wet and dry seasons. Water levels in these two wells declined approximately 40 feet from the wet season to the dry season, however, part of the decline is because of pumping in the two wells during the period. The Foster and Guerrero wells have shown little to no seasonal water level fluctuations over the monitoring period.

## **Ground Water Movement**

Estimated ground water flow directions and hydraulic gradients on the Woodlands property are shown in Figure 4. Ground water is inferred to flow to the northwest at an estimated average hydraulic gradient of 0.00138 vertical feet of head loss per horizontal foot of distance. Wells used for the hydraulic gradient calculations represent the same or similar hydraulic pressure zones. The eight offsite wells and the onsite Flintcote and Highway 1 Monitoring wells are completed in separate pressure zones, and therefore, were not used in the gradient calculations.

**Figure 3**  
**Water Levels: October 1999 - February 2004**  
**The Woodlands Offsite Wells**

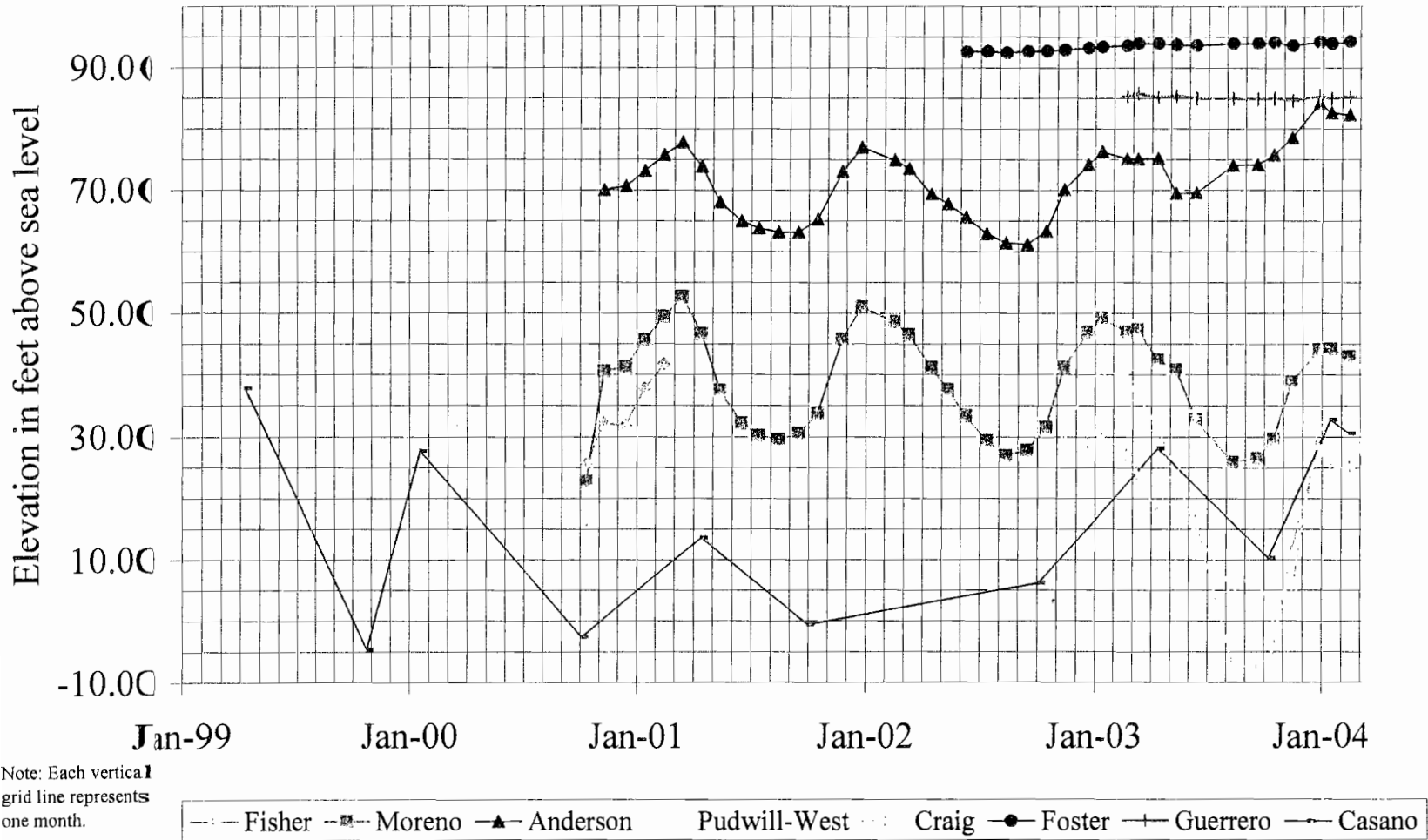

TABLE 1  
Woodlands Offsite Wells

Well Owner	Common Well Name	Well Number	Reference Point	Total depth (in feet)	Well Type	Well Status	Date Monitoring Began	Drillers	Year Drilled	Comments
Martha Anderson PO. Box 452 Nipomo, CA 93444 929-4752	Anderson	11N/35W-14N	Top of sounding tube (271.2)	--	Irrigation	Equipped, inactive	Nov-00	Floyd V. Wells	1975	
Ken Craig P.O. Box 505 Oceano, CA 93445 489-2263	Craig	11N/35W-10F	Steel plate on top of casing (277.9)	600	School supply & Irrigation	Unequipped	Dec-03	Enloe Well Drilling	2002	Cascading water enters well at approximately 206 feet depth
Marlin Fisher 1680 Dawn Rd. Nipomo, CA 93444 343-2120	Fisher	11N/35W-10N	Top of casing (est. 240)	360	Domestic	Active	Oct-00	Floyd V. Wells	1981	Discontinued Feb-01
Homer Foster 1345 Banneker Pl. Nipomo, CA 93444 343-2782	Foster	11N/35W-23E1	Top of casing (298.5)	460	Domestic	Active	Jun-03	Water Well Supply	1992	
Henry Guerrero, Sr., 1107 West Jewe St. Santa Maria, CA 93458 925-4012	Guerrero	11N/35W-22G	Top of casing (279.8)	--	Domestic	Equipped, inactive	Feb-03	--	--	
Pete Moreno 1552 Camino Cavallo Nipomo, CA 93444 343-1644	Moreno	11N/35W-15G1	Top of sounding tube (234.8)	380	Domestic	Active	Oct-00	Water Well Supply	1985	Pump set at 225 feet depth
James Pudwill 880 Sun Dale Way Nipomo, CA 93444 343-1523	Pudwill- West	11N/35W-10R2	Top of casing (269.1)	365	Domestic / Irrigation	Active	Nov-03	--	Prior to 1973	Pumping often
Casano, Paul and Mary 797 Guadalupe Road, Arroyo Grande, CA 343-2186	Casano	11N/35W-9K4	Top of sounding port (County GPS=168.53)	--	Domestic	Active	Jan-2004 by Cleath & Associates	Floyd V. Wells	1960's	Monitored by County Public Works Dept. in October and April since 1973



**Conclusions and Recommendations**

There are a total of 13 wells currently being monitored on a monthly basis for the Woodlands project. Based on observed water levels, there are at least three different pressure zones being tapped by the various wells. The fact that the two offsite Banneker Place wells show virtually no seasonal changes in water levels suggests that they have been completed within a unique zone. The offsite Craig well taps a deeper and separate zone than the other offsite wells. The onsite Highway 1 Monitoring well is in a separate pressure zone as evidenced by ground water elevations between 9 and 20 feet higher than ground water elevations observed in the Highway 1 Production well, located approximately 65 feet to the north. The Flintcote well is shallower than the other onsite wells and as a result, water levels are affected by the wet and dry seasons sooner than the deeper onsite wells.

The Homestead well and the Highway 1 Production well are now equipped with pumps. Cleath & Associates recommends equipping these wells and each of the onsite wells with a flow meter as they are equipped for production.

Water level data sheets including depths to ground water, ground water elevations, and changes in water levels for each well are included as an attachment. If you have any questions regarding this letter report, please call our office.

Sincerely,

David R. Williams  
Staff Geologist

attachments

Water levels Mesa Road Well

**The Woodlands Onsite**

Reference Point: 243.3 feet above sea level

Date	Depth	Water Elev.	Change
3/2/99	196.51	46.79	
4/5/99	193.65	49.65	-2.86
5/12/99	208.17	35.13	14.52
6/9/99	210.72	32.58	2.55
7/16/99	220.75	22.55	10.03
8/12/99	218.09	25.21	-2.66
9/14/99	217.36	25.94	-0.73
10/14/99	215.25	28.05	-2.11
11/16/99	202.82	40.48	-12.43
12/15/99	201.51	41.79	-1.31
1/14/00	201.49	41.81	-0.02
2/15/00	190.94	52.36	-10.55
3/17/00	196.15	47.15	5.21
4/18/00	200.97	42.33	4.82
5/16/00	209.48	33.82	8.51
6/14/00	214.23	29.07	4.75
7/17/00	217.15	26.15	2.92
8/16/00	223.06	20.24	5.91
9/15/00	223.77	19.53	0.71
10/12/00	216.67	26.63	-7.10
11/10/00	205.96	37.34	-10.71
12/15/00	202.10	41.20	-3.86
1/15/01	195.96	47.34	-6.14
2/15/01	192.63	50.67	-3.33
3/16/01	191.13	52.17	-1.50
4/16/01	197.75	45.55	6.62
5/15/01	211.18	32.12	13.43
6/18/01	218.73	24.57	7.55
7/16/01	219.28	24.02	0.55
8/16/01	219.83	23.47	0.55
9/17/01	222.22	21.08	2.39
10/18/01	214.53	28.77	-7.69
11/26/01	197.09	46.21	-17.44
12/27/01	192.06	51.24	-5.03
2/18/02	196.38	46.92	4.32
3/13/02	199.74	43.56	3.36
4/18/02	211.57	31.73	11.83
5/15/02	213.26	30.04	1.69
6/13/02	218.88	24.42	5.62
7/16/02	222.75	20.55	3.87
8/15/02	227.89	15.41	9.01
9/18/02	227.00	16.30	-0.89
10/18/02	222.02	21.28	-4.98
11/15/02	205.19	38.11	-16.83
12/23/02	196.74	46.56	-8.45
1/15/03	195.75	47.55	-0.99
2/24/03	197.60	45.70	1.85
3/14/03	200.87	42.43	3.27
4/15/03	205.38	37.92	4.51

Water levels Mesa Road Well

**The Woodlands Onsite**

Reference Point: 243.3 feet above sea level

Date	Depth	Water Elev.	Change
5/15/03	214.25	29.05	8.87
6/17/03	222.43	20.87	8.18
8/15/03	230.47	12.83	8.04
9/24/03	226.93	16.37	-3.54
10/20/03	220.2	23.10	-6.73
11/18/03	225.31	17.99	5.11
12/31/03	203.42	39.88	-21.89
1/19/04	203.62	39.68	0.20
2/17/04	204.84	38.46	1.22



Water levels Dawn Well

**The Woodlands Onsite**

Reference Point: 248.1 feet above sea level

Date	Depth	Water Elev.	Change
3/2/99	214.33	33.77	
4/5/99	210.96	37.14	-3.37
5/12/99	225.20	22.90	14.24
6/9/99	229.21	18.89	4.01
7/16/99	233.67	14.43	4.46
8/12/99	233.55	14.55	-0.12
9/14/99	231.49	16.61	-2.06
10/14/99	231.03	17.07	-0.46
11/16/99	220.46	27.64	-10.57
12/15/99	218.23	29.87	-2.23
1/14/00	219.30	28.80	1.07
2/15/00	206.79	41.31	-12.51
3/17/00	207.77	40.33	0.98
4/18/00	217.77	30.33	10.00
5/16/00	228.61	19.49	10.84
6/14/00	234.62	13.48	16.85
7/17/00	236.36	11.74	18.59
8/16/00	239.55	8.55	21.78
9/15/00	239.57	8.53	21.80
10/12/00	229.02	19.08	11.25
11/10/00	220.07	28.03	-8.54
12/15/00	220.75	27.35	-13.87
1/15/01	212.50	35.60	-23.86
2/15/01	208.30	39.80	-31.25
3/16/01	205.05	43.05	-3.25
4/16/01	212.84	35.26	7.79
5/15/01	228.38	19.72	15.54
6/18/01	234.88	13.22	6.50
7/16/01	236.09	12.01	1.21
8/16/01	238.94	9.16	2.85
9/17/01	236.57	11.53	-2.37
10/18/01	231.20	16.90	-5.37
11/26/01	212.88	35.22	-18.32
12/27/01	207.58	40.52	-5.30
2/18/02	211.13	36.97	3.55
3/13/02	214.58	33.52	3.45
4/18/02	223.98	24.12	9.40
5/15/02	231.31	16.79	7.33
6/13/02	237.23	10.87	5.92
7/16/02	241.72	6.38	4.49
8/15/02	241.94	6.16	0.22
9/18/02	241.33	6.77	-0.61
10/18/02	235.42	12.68	-5.91
11/15/02	220.88	27.22	-14.54
12/23/02	212.27	35.83	-8.61
1/15/03	210.51	37.59	-1.76
2/24/03	212.33	35.77	1.82
3/14/03	216.54	31.56	4.21
4/15/03	221.76	26.34	5.22

Water levels Dawn Well

**The Woodlands Onsite**

Reference Point: 248.1 feet above sea level

Date	Depth	Water Elev.	Change
5/15/03	222.56	25.54	0.80
6/17/03	236.23	11.87	13.67
8/15/03	244.40	3.70	8.17
9/24/03	243.89	4.21	-0.51
10/20/03	239.31	8.79	-4.58
11/18/03	209.96	38.14	-29.35
12/31/03	214.08	34.02	4.12
1/19/04	214.72	33.38	0.64
2/17/04	215.80	32.30	1.08

Water levels Highway 1 Production Well

The Woodlands Onsite

Reference Point: 245.3 feet above sea level

Date	Depth	Water Elev.	Change
3/2/99	207.24	38.06	
4/5/99	204.77	40.53	2.47
5/12/99	217.31	27.99	-12.54
6/9/99	221.33	23.97	-4.02
7/16/99	228.24	17.06	-6.91
8/12/99	227.54	17.76	0.70
9/14/99	225.75	19.55	1.79
10/14/99	224.66	20.64	1.09
11/16/99	212.89	32.41	11.77
12/15/99	211.22	34.08	1.67
1/14/00	211.85	33.45	-0.63
2/15/00	201.33	43.97	10.52
3/17/00	203.39	41.91	-2.06
4/18/00	211.94	33.36	-8.55
5/16/00	219.96	25.34	-8.02
6/14/00	225.13	20.17	-13.19
7/17/00	227.59	17.71	-15.65
8/16/00	229.78	15.52	-17.84
9/15/00	230.52	14.78	-18.58
10/12/00	223.06	22.24	-11.12
11/10/00	214.59	30.71	5.37
12/15/00	212.05	33.25	-13.08
1/15/01	206.92	38.38	-20.67
2/15/01	203.17	42.13	-26.61
3/16/01	201.03	44.27	2.14
4/16/01	207.68	37.62	-6.65
5/15/01	220.80	24.50	-13.12
6/18/01	226.28	19.02	-5.48
7/16/01	227.33	17.97	-1.05
8/16/01	229.58	15.72	-2.25
9/17/01	228.72	16.58	0.86
10/18/01	223.90	21.40	4.82
11/26/01	206.82	38.48	17.08
12/27/01	201.01	44.29	5.81
2/18/02	206.53	38.77	-5.52
3/13/02	210.52	34.78	-3.99
4/18/02	219.70	25.60	-9.18
5/15/02	223.26	22.04	-3.56
6/13/02	228.09	17.21	-4.83
7/16/02	232.62	12.68	-4.53
8/15/02	236.58	8.72	-3.96
9/18/02	235.56	9.74	1.02
10/18/02	229.83	15.47	5.73
11/15/02	214.79	30.51	15.04
12/23/02	207.08	38.22	7.71
1/15/03	205.84	39.46	1.24
2/24/03	208.32	36.98	-2.48
3/17/03	210.10	35.18	-1.00
4/15/03	215.04	30.26	-4.86
5/15/03	220.33	24.97	-5.29
6/17/03	229.20	16.10	-8.87

Water levels Highway 1 Production Well

**The Woodlands Onsite**

Reference Point: 245.3 feet above sea level

Date	Depth	Water Elev.	Change
8/15/03	238.44	6.86	-9.24
9/24/03	235.93	9.37	2.51
10/20/03	230.79	14.51	5.14
11/18/03	217.79	27.51	13.00
12/31/03	210.7	34.60	7.09
1/19/04	211.34	33.96	-0.64
2/17/04	212.58	32.72	-1.24

Water levels Highway 1 Monitoring Well

**The Woodlands Onsite**

Reference Point: 244.3 feet above sea level

Date	Depth	Water Elev.	Change
3/2/99	195.03	49.27	
4/5/99	193.27	51.03	1.76
5/12/99	201.96	42.34	-8.69
6/9/99	205.07	39.23	-3.11
7/16/99	210.32	33.98	-5.25
8/12/99	209.00	35.30	1.32
9/14/99	208.57	35.73	0.43
10/14/99	206.03	38.27	2.54
11/16/99	199.14	45.16	6.89
12/15/99	198.25	46.05	0.89
1/14/00	197.98	46.32	0.27
2/15/00	190.40	53.90	7.58
3/17/00	191.55	52.75	-1.15
4/18/00	198.13	46.17	-6.58
5/16/00	203.86	40.44	-5.73
6/14/00	207.77	36.53	-9.64
7/17/00	209.80	34.50	-11.67
8/16/00	211.50	32.80	-13.37
9/15/00	212.12	32.18	-13.99
10/12/00	206.63	37.67	-8.50
11/10/00	200.17	44.13	3.69
12/15/00	198.23	46.07	-9.54
1/15/01	194.45	49.85	-15.35
2/15/01	191.69	52.61	-19.81
3/16/01	189.93	54.37	1.76
4/16/01	194.70	49.60	-4.77
5/15/01	204.48	39.82	-9.78
6/18/01	208.80	35.50	-4.32
7/16/01	209.65	34.65	-0.85
8/16/01	211.28	33.02	-1.63
9/17/01	210.62	33.68	0.66
10/18/01	206.82	37.48	3.80
11/26/01	194.48	49.82	12.34
12/27/01	191.03	53.27	3.45
2/18/02	193.83	50.47	-2.80
3/13/02	196.68	47.62	-2.85
4/18/02	203.41	40.89	-6.73
5/15/02	206.23	38.07	-2.82
6/13/02	209.99	34.31	-3.76
7/16/02	213.76	30.54	-3.77
8/15/02	216.59	27.71	-2.83
9/18/02	215.88	28.42	0.71
10/18/02	211.33	32.97	4.55
11/15/02	200.40	43.90	10.93
12/23/02	194.60	49.70	5.80
1/15/03	193.67	50.63	0.93
2/24/03	195.45	48.85	-1.78
3/14/03	196.53	47.77	-1.08
4/15/03	200.58	43.72	-4.05
5/15/03	204.20	40.10	-3.62
6/17/03	211.25	33.05	-7.05

Water levels Highway 1 Monitoring Well

**The Woodlands Onsite**

Reference Point: 244.3 feet above sea level

Date	Depth	Water Elev.	Change
8/15/03	218.64	25.66	-7.39
9/24/03	216.79	27.51	1.85
10/20/03	212.75	31.55	4.04
11/18/03	203.52	40.78	9.23
12/31/03	200.67	43.63	2.85
1/19/04	201.08	43.22	-0.41
2/17/04	202.19	42.11	-1.11

Water levels Homestead Well

**The Woodlands Onsite**

Reference Point: 184.9 feet above sea level

Date	Depth	Water Elev.	Change
3/2/99	140.09	44.81	
4/5/99	137.75	47.15	-2.34
5/12/99	150.81	34.09	13.06
6/9/99	154.00	30.90	3.19
7/16/99	161.05	23.85	7.05
8/12/99	160.07	24.83	-0.98
9/14/99	158.10	26.80	-1.97
10/14/99	156.79	28.11	-1.31
11/16/99	144.62	40.28	-12.17
12/15/99	144.00	40.90	-0.62
1/14/00	143.96	40.94	-0.04
2/15/00	133.18	51.72	-10.78
3/17/00	134.80	50.10	1.62
4/18/00	143.30	41.60	8.50
5/16/00	151.60	33.30	8.30
6/14/00	156.13	28.77	12.83
7/17/00	159.37	25.53	16.07
8/16/00	162.52	22.38	19.22
9/15/00	163.25	21.65	19.95
10/12/00	154.50	30.40	11.20
11/10/00	146.79	38.11	-4.81
12/15/00	143.66	41.24	-12.47
1/15/01	138.29	46.61	-21.08
2/15/01	134.95	49.95	-27.57
3/16/01	133.26	51.64	-1.69
4/16/01	140.36	44.54	7.10
5/15/01	153.48	31.42	13.12
6/18/01	158.42	26.48	4.94
7/16/01	159.79	25.11	1.37
8/16/01	161.83	23.07	2.04
9/17/01	161.53	23.37	-0.30
10/18/01	155.22	29.68	-6.31
11/26/01	139.32	45.58	-15.90
12/27/01	134.63	50.27	-4.69
2/18/02	139.33	45.57	4.70
3/13/02	142.33	42.57	3.00
4/18/02	152.38	32.52	10.05
5/15/02	155.77	29.13	3.39
6/13/02	159.79	25.11	4.02
7/16/02	164.44	20.46	4.65
8/15/02	168.51	16.39	4.07
9/18/02	164.96	19.94	-3.55
10/18/02	161.52	23.38	-3.44
11/15/02	146.06	38.84	-15.46
12/23/02	139.6	45.30	-6.46
1/15/03	138.24	46.66	-1.36
2/24/03	140.34	44.56	2.10
3/14/03	143.31	41.59	2.97
4/15/03	148.23	36.67	4.92
5/15/03	--	--	--
6/17/03	161.11	23.79	12.88

Water levels Homestead Well

**The Woodlands Onsite**

Reference Point: 184.9 feet above sea level

Date	Depth	Water Elev.	Change
8/15/03	173.33	11.57	12.22
9/24/03	169.96	14.94	-3.37
10/20/03	165.02	19.88	-4.94
11/18/03	152.48	32.42	-12.54
12/31/03	143.33	41.57	-9.15
1/19/04	146.1	38.80	2.77
2/17/04	161.13	23.77	15.03



Water Levels Flintcote Well

The Woodlands Onsite

Reference Point: 241.6 feet above sea level

Date	Depth	Water Elev.	Change
10/3/1944	195	46.60	
8/1/1992	231	10.60	
3/2/99	195.91	45.69	0.91
4/5/99	194.08	47.52	-1.83
5/12/99	205.63	35.97	11.55
6/9/99	209.88	31.72	4.25
7/16/99	216.54	25.06	6.66
8/12/99	215.64	25.96	-0.90
9/14/99	215.18	26.42	-0.46
10/14/99	212.68	28.92	-2.50
11/16/99	204.53	37.07	-8.15
12/15/99	201.81	39.79	-2.72
1/14/00	202.39	39.21	0.58
2/15/00	192.50	49.10	-9.89
3/17/00	192.05	49.55	-0.45
4/18/00	203.88	37.72	11.83
5/16/00	209.49	32.11	5.61
6/14/00	212.12	29.48	8.24
7/17/00	216.90	24.70	13.02
8/16/00	218.78	22.82	14.90
9/15/00	219.87	21.73	15.99
10/12/00	214.51	27.09	10.63
11/10/00	204.09	37.51	-5.40
12/15/00	202.88	38.72	-9.24
1/15/01	198.38	43.22	-18.52
2/15/01	194.21	47.39	-24.57
3/16/01	190.34	51.26	-3.87
4/16/01	197.90	43.70	7.56
5/15/01	210.21	31.39	12.31
6/18/01	215.51	26.09	5.30
7/16/01	217.17	24.43	1.66
8/16/01	218.01	23.59	0.84
9/17/01	217.98	23.62	-0.03
10/18/01	212.81	28.79	-5.17
11/26/01	198.48	43.12	-14.33
12/27/01	192.63	48.97	-5.85
2/18/02	197.47	44.13	4.84
3/13/02	199.73	41.87	2.26
4/18/02	207.49	34.11	7.76
5/15/02	210.88	30.72	3.39
6/13/02	215.05	26.55	4.17
7/16/02	220.24	21.36	5.19
8/15/02	224.37	17.23	4.13
9/18/02	223.25	18.35	-1.12
10/18/02	218.21	23.39	-5.04
11/15/02	205.17	36.43	-13.04
12/23/02	198.54	43.06	-6.63
1/15/03	195.03	45.67	-2.61
2/24/03	198.45	43.15	2.52
3/14/03	199.01	42.59	0.56
4/15/03	206.65	34.95	7.64

Water Levels Flintcote Well

**The Woodlands Onsite**

Reference Point: 241.6 feet above sea level

Date	Depth	Water Elev.	Change
5/15/03	208.68	32.92	2.03
6/17/03	218.73	22.87	10.05
8/15/03	225.73	15.87	7.00
9/24/03	224.87	16.73	-0.86
10/20/03	219.99	21.61	-4.88
11/18/03	209.67	31.93	-10.32
12/31/03	201.22	40.38	-8.45
1/19/04	201.06	40.54	-0.16
2/17/04	203.17	38.43	2.11

Water levels Anderson Well

**The Woodlands Offsite**

Reference Point: 271.2 feet above sea level

Date	Depth	Water Elev.	Change
11/10/00	201.00	70.20	--
12/15/00	200.38	70.82	-0.62
1/15/01	197.88	73.32	-2.50
2/15/01	195.28	75.92	-2.60
3/16/01	193.19	78.01	-2.09
4/16/01	197.18	74.02	3.99
5/15/01	203.05	68.15	5.87
6/18/01	206.12	65.08	3.07
7/16/01	207.30	63.90	1.18
8/16/01	207.93	63.27	0.63
9/17/01	207.95	63.25	0.02
10/18/01	205.83	65.37	-2.12
11/26/01	198.01	73.19	-7.82
12/27/01	194.05	77.15	-3.96
2/18/02	196.13	75.07	2.08
3/13/02	197.55	73.65	1.42
4/18/02	201.74	69.46	4.19
5/15/02	203.33	67.87	1.59
6/13/02	205.49	65.71	2.16
7/16/02	208.19	63.01	2.70
8/15/02	209.65	61.55	1.46
9/18/02	209.88	61.32	0.23
10/18/02	207.77	63.43	-2.11
11/15/02	200.96	70.24	-6.81
12/23/02	196.92	74.28	-4.04
1/15/03	194.80	76.40	-2.12
2/24/03	195.98	75.22	1.18
3/14/03	195.95	75.25	-0.03
4/15/03	195.88	75.32	-0.07
5/15/03	201.60	69.60	5.72
6/17/03	201.49	69.71	-0.11
8/15/03	197.02	74.18	-4.47
9/24/03	7/14/00	74.31	-0.13
10/20/03	195.32	75.88	-1.57
11/18/03	192.49	78.71	-2.83
12/31/03	186.89	84.31	-5.60
1/19/04	188.46	82.74	1.57
2/17/04	188.8	82.40	0.34

Water levels Moreno Well

**The Woodlands Offsite**

Reference Point: 234.8 feet above sea level

Date	Depth	Water Elev.	Change
10/12/00	211.94	22.86	--
11/10/00	194.16	40.64	-17.78
12/15/00	193.45	41.35	-0.71
1/15/01	189.03	45.77	-4.42
2/15/01	185.21	49.59	-3.82
3/16/01	182.00	52.80	-3.21
4/16/01	188.00	46.80	6.00
5/15/01	197.28	37.52	9.28
6/18/01	202.46	32.34	5.18
7/16/01	204.43	30.37	1.97
8/16/01	205.06	29.74	0.63
9/17/01	204.11	30.69	-0.95
10/18/01	200.91	33.89	-3.20
11/26/01	188.96	45.84	-11.95
12/27/01	183.68	51.12	-5.28
2/18/02	186.08	48.72	2.40
3/13/02	188.20	46.60	2.12
4/18/02	193.54	41.26	5.34
5/15/02	197.13	37.67	3.59
6/13/02	201.31	33.49	4.18
7/16/02	205.28	29.52	3.97
8/15/02	207.78	27.02	2.50
9/18/02	206.85	27.95	-0.93
10/18/02	203.13	31.67	-3.72
11/15/02	193.54	41.26	-9.59
12/23/02	187.75	47.05	-5.79
1/15/03	185.45	49.35	-2.30
2/24/03	187.73	47.07	2.28
3/14/03	187.35	47.45	-0.38
4/15/03	192.31	42.49	4.96
5/15/03	193.87	40.93	1.56
6/17/03	201.92	32.88	8.05
8/15/03	208.81	25.99	6.89
9/24/03	208.17	26.63	-0.64
10/20/03	204.96	29.84	-3.21
11/18/03	195.85	38.95	-9.11
12/31/03	190.57	44.23	-5.28
1/19/04	190.51	44.29	-0.06
2/17/04	191.74	43.06	1.23

Water levels Foster Well

**The Woodlands Offsite**

Reference Point: 298.5 feet above sea level

Date	Depth	Water Elev.	Change
6/13/02	205.87	92.63	--
7/16/02	205.75	92.75	-0.12
8/15/02	205.97	92.53	0.22
9/18/02	205.76	92.74	-0.21
10/18/02	205.71	92.79	-0.05
11/15/02	205.48	93.02	-0.23
12/23/02	205.22	93.28	-0.26
1/15/03	205.05	93.45	-0.17
2/24/03	204.88	93.62	-0.17
3/14/03	204.52	93.98	-0.36
4/15/03	204.48	94.02	-0.04
5/15/03	204.71	93.79	0.23
6/17/03	204.83	93.67	0.12
8/15/03	204.48	94.02	-0.35
9/24/03	204.51	93.99	0.03
10/20/03	204.33	94.17	-0.18
11/18/03	204.80	93.70	0.47
12/31/03	204.22	94.28	-0.58
1/19/04	204.50	94.00	0.28
2/17/04	204.12	94.38	-0.38

Water levels Guerrero Well

**The Woodlands Offsite**

Reference Point: 279.8 feet above sea level

Date	Depth	Water Elev.	Change
2/24/03	194.52	103.98	--
3/14/03	194.09	104.41	-0.43
4/15/03	194.65	103.85	0.56
5/15/03	194.41	104.09	-0.24
6/17/03	194.84	103.66	0.43
8/15/03	194.88	103.62	0.04
9/24/03	194.93	103.57	0.05
10/20/03	194.83	103.67	-0.10
11/18/03	195.16	103.34	0.33
12/31/03	194.41	104.09	-0.75
1/19/04	194.84	103.00	0.43
2/17/04	194.53	103.97	-0.31

Water levels Craig Well  
**The Woodlands Offsite**

Reference Point: 277.9 feet above sea level

Date	Depth	Water Elev.	Change
12/23/02	248.79	29.11	—
1/15/03	247.70	30.20	-1.09
2/24/03	250.68	27.22	2.98
3/14/03	253.63	24.27	2.95
4/15/03	260.19	17.71	6.56
5/15/03	258.32	19.58	-1.87
6/17/03	261.21	16.69	2.89
8/15/03	284.50	-6.60	23.29
9/24/03	285.91	-8.01	1.41
10/20/03	282.61	-4.71	-3.30
11/18/03	266.57	11.33	-16.04
12/31/03	249.66	28.24	-16.91
1/19/04	253.19	24.71	3.53
2/17/04	252.77	25.13	-0.42

Water levels Pudwill - West Well  
**The Woodlands Offsite**

Reference Point: 269.1 feet above sea level

Date	Depth	Water Elev.	Change
11/15/02	238.80	39.10	—
12/23/02	230.28	47.62	-8.52
1/15/03	228.55	49.35	-1.73
2/24/03	229.31	48.59	0.76
3/14/03	232.45	45.45	3.14
4/15/03	237.12	40.78	4.67
5/15/03	244.78	33.12	7.66
6/17/03	254.51	23.39	9.73
8/15/03	263.51	14.39	9.00
9/24/03	261.36	16.54	-2.15
10/20/03	—	—	—
11/18/03	265.00	12.90	3.64
12/31/03	237.20	40.70	-27.80
1/19/04	--	--	--
2/17/04	--	--	--

Water levels Casano Well

**The Woodlands Offsite**

\*Reference Point: 168.5 feet above sea level

Date	Depth	Water Elev.	Change
4/10/99	130.6	37.90	
10/26/99	173	-4.50	42.40
1/19/00	140.7	27.80	-32.30
10/5/00	171	-2.50	30.30
4/16/01	154.8	13.70	-16.20
10/3/01	169.00	-0.50	14.20
10/7/02	162.20	6.30	-6.80
4/16/03	140.20	28.30	-22.00
10/13/03	158.10	10.40	17.90
1/19/04	135.58	32.92	-22.52
2/17/04	137.72	30.78	2.14

\*Reference point based on San Luis Obispo County GPS measurement.

Well levels shown from April 1999 to October 2003 were monitored by the San Luis Obispo County Public Works Department as part of the County's Ground Water Monitoring Program. Cleath & Associates began monitoring the well on January 19, 2004.

Water levels Fisher Well

**The Woodlands Offsite**

\*Reference Point: 240 feet above sea level

Date	Depth	Water Elev.	Change
10/12/00	214.32	25.68	--
11/10/00	207.65	32.35	-6.67
12/15/00	208.02	31.98	0.37
1/15/01	202.15	37.85	-5.87
2/15/01	198.15	41.85	-4.00

\* Reference point estimated from topographic map.

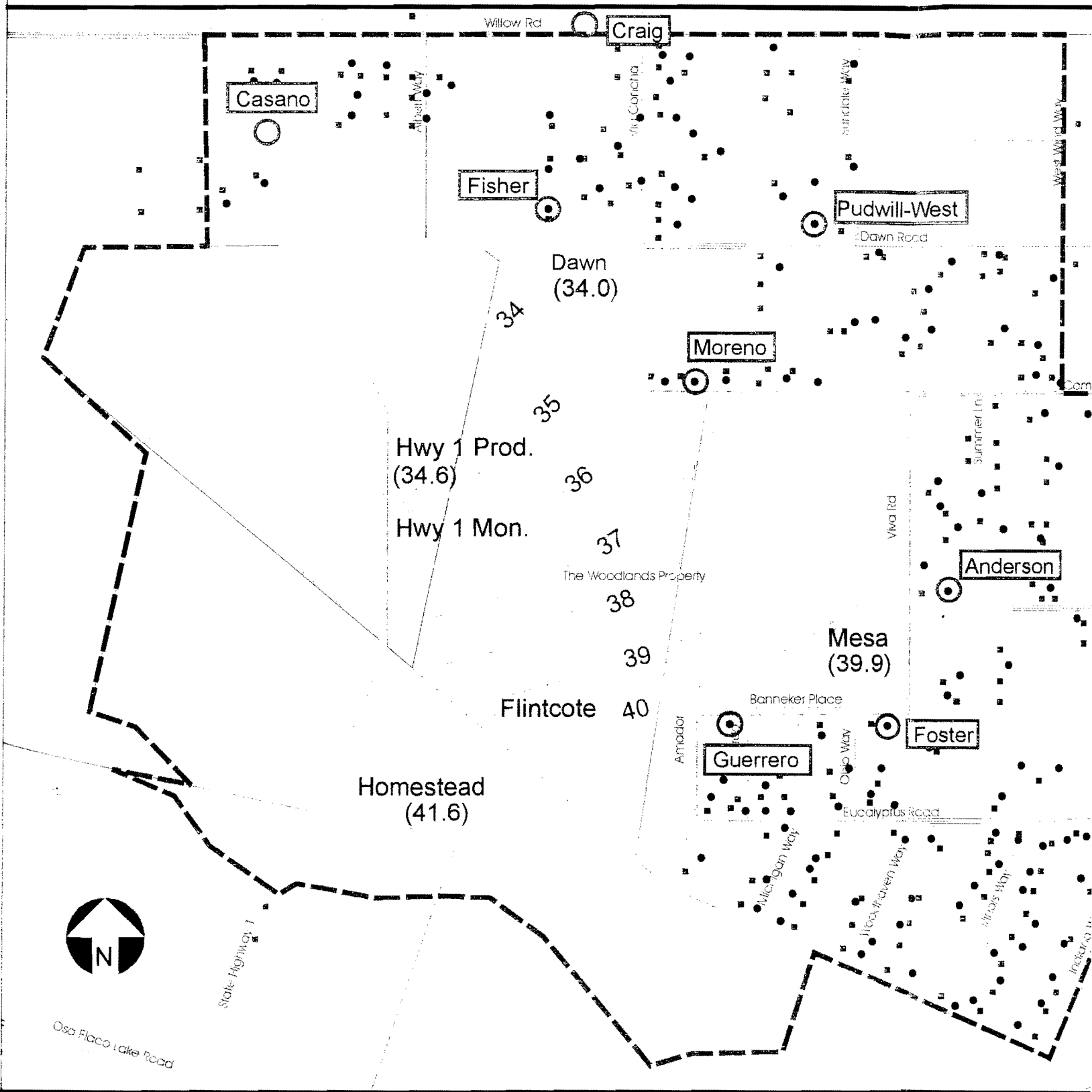





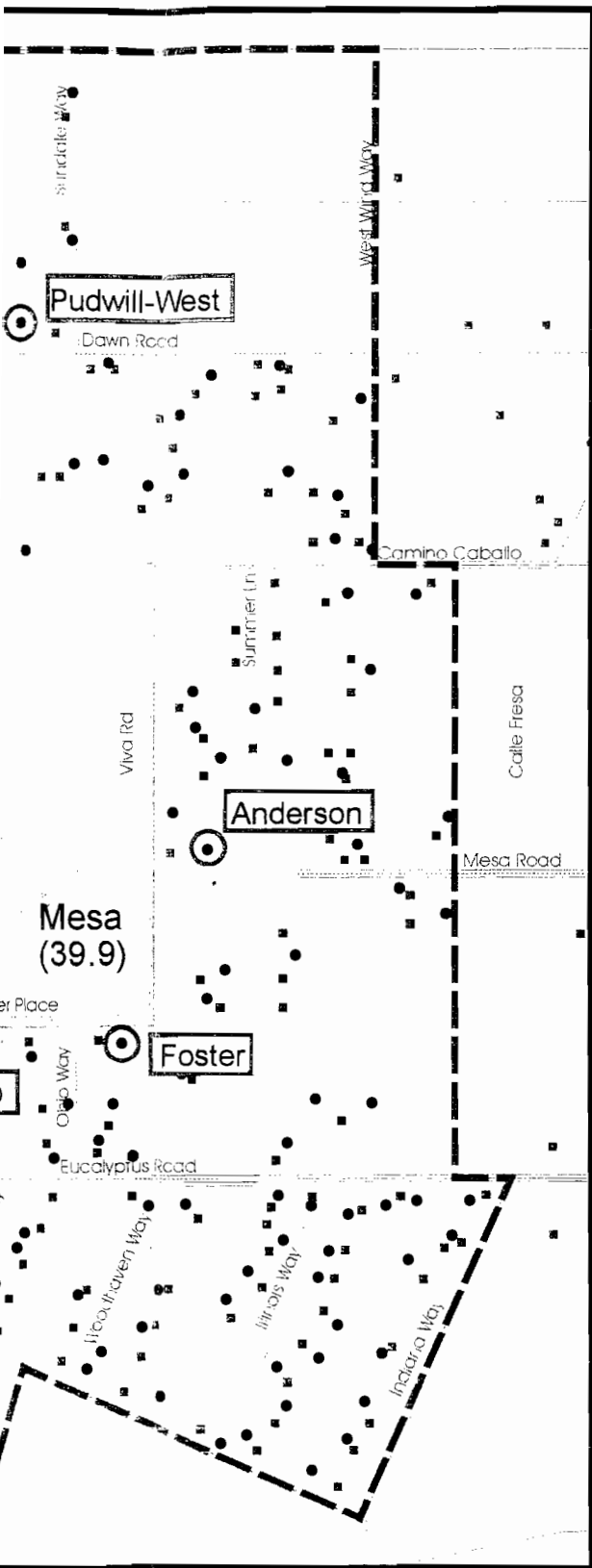

Note:  
 Ground water contours are determined based on the water levels  
 in four onsite wells only, and should not be extrapolated outward  
 beyond what is shown without incorporating additional well data points.

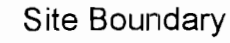
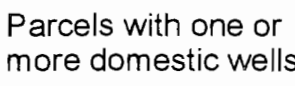

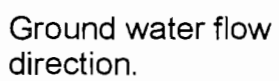

**EXPLANATION:**

-  Impact Area Boundary
-  Site Boundary
-  Parcels with one or more domestic wells
-  Houses
-  Domestic Wells (Inferred)
-  Offsite Monitoring Well Location
-  Dawn (34.0) Onsite Monitoring Well Location, ground water elevation in feet above sea level
-  40 Ground water elevation contour on December 31, 2003, elevation in feet above sea level
-  Ground water flow direction.

Base Map: San Luis Obispo County  
 Building & Planning Dept.  
 Assessor's Parcel Maps

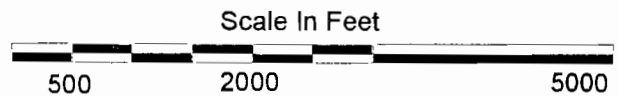

**Figure 4**  
**Ground Water Elevation**  
**Contours on December 31,**  
**2003**

**The Woodlands**  
 Cleath & Associates  
 March 2004