

Exhibit 1D

CURRENT PLANNED CITY SERVICE AREA

107-150-001	111-014-001	117-191-010
107-150-002	111-014-002	117-191-013
107-150-007	111-014-003	
107-150-013	111-014-004	117-820-001
107-150-015	111-014-005	117-820-002
107-150-016	111-014-006	117-820-024
107-150-018	111-014-007	117-820-025
107-150-019	111-014-008	128-078-004
	111-014-009	128-078-005
	111-014-010	128-078-013
107-240-005	111-014-011	
107-240-006	111-014-012	
107-240-008	111-014-013	128-091-001
107-240-027	111-014-014	128-091-005
107-240-028		128-091-006
107-240-029		128-091-007
	111-015-001	
111-011-001	111-015-002	128-094-012
111-011-002	111-015-003	128-094-014
111-011-003	111-015-004	128-094-016
111-011-004	111-015-005	128-094-042
111-011-005	111-015-006	128-094-047
111-011-006	111-015-007	
111-011-007	111-015-008	129-010-001
111-011-008		129-010-012
111-011-009		129-010-013
111-011-010		129-010-021
111-011-011		129-010-022
111-011-012		129-010-023
111-011-013		129-010-024

CITY OF SANTA MARIA
WASTE WATER
TREATMENT PLANT
SANTA MARIA CITY LIMITS

111-012-001	111-020-002	
111-012-002	111-020-003	
111-012-003	111-020-009	
111-012-004	111-020-011	
111-012-005	111-020-013	
111-012-006	111-020-014	
	111-020-016	
111-013-001		
111-013-002		
111-013-003	111-030-003	
111-013-004	111-030-015	
111-013-005	111-030-016	
111-013-006	111-030-018	
111-013-007	111-030-023	
111-013-008	111-030-024	
111-013-009	111-030-025	
111-013-010	111-030-026	
111-013-011		
111-013-012		
111-013-013	111-130-001	
111-013-014		

1 2 3 4 5 6 7 8 9 10 11 12 13 14 15 16

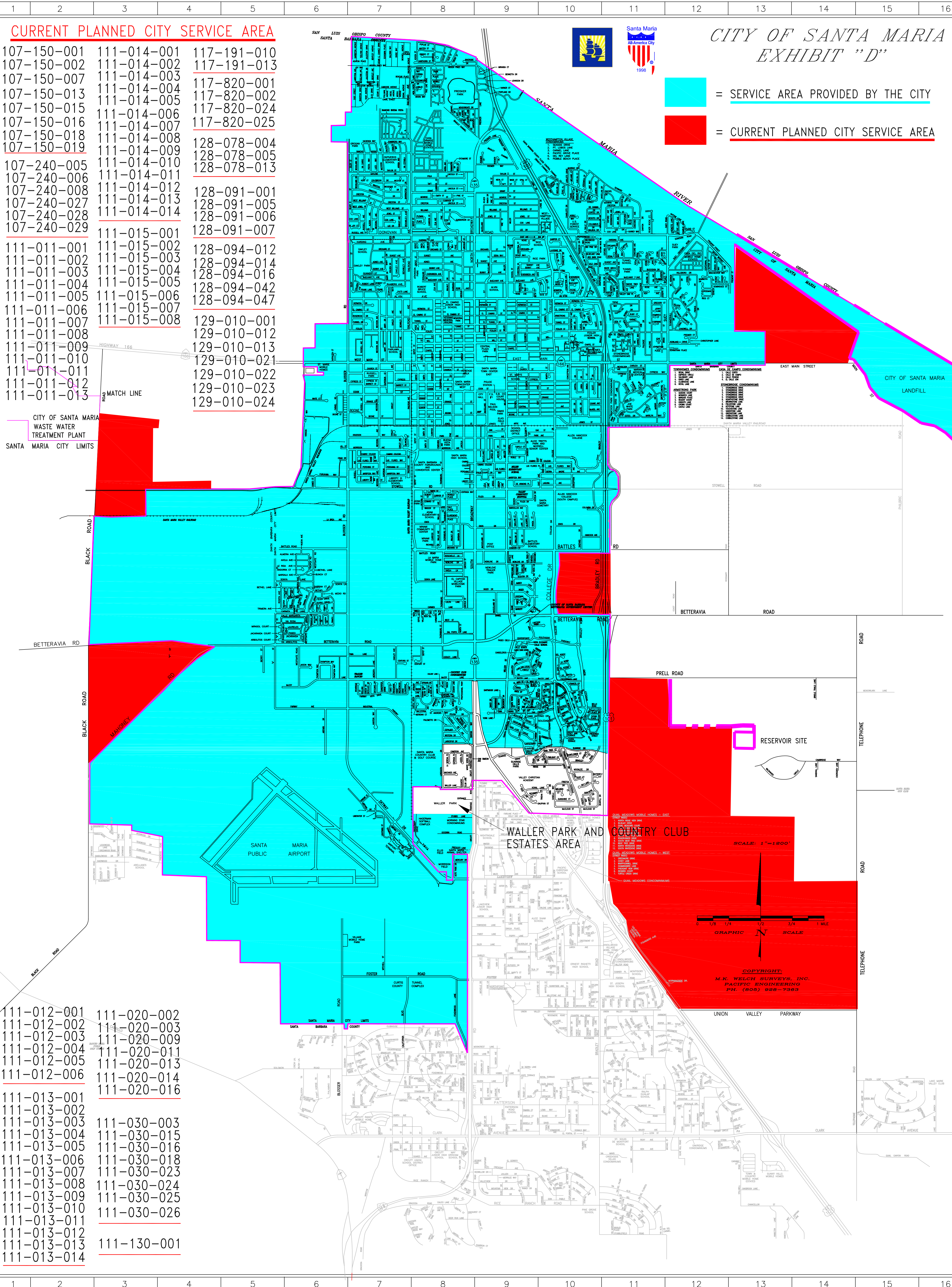

**CITY OF SANTA MARIA
EXHIBIT "D"**

Cyan = SERVICE AREA PROVIDED BY THE CITY
Red = CURRENT PLANNED CITY SERVICE AREA

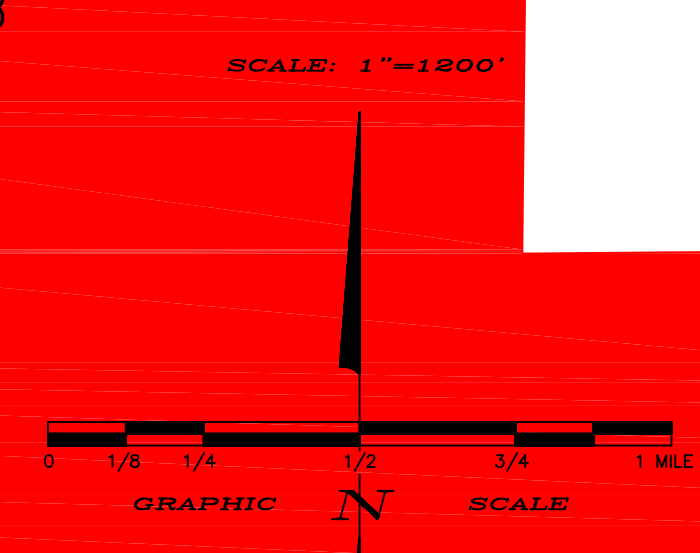

COPYRIGHT:
M.K. WELCH SURVEYS, INC.
PACIFIC ENGINEERING
PH. (805) 928-7965

**Figure 1 – Sphere of Influence
City of Arroyo Grande**

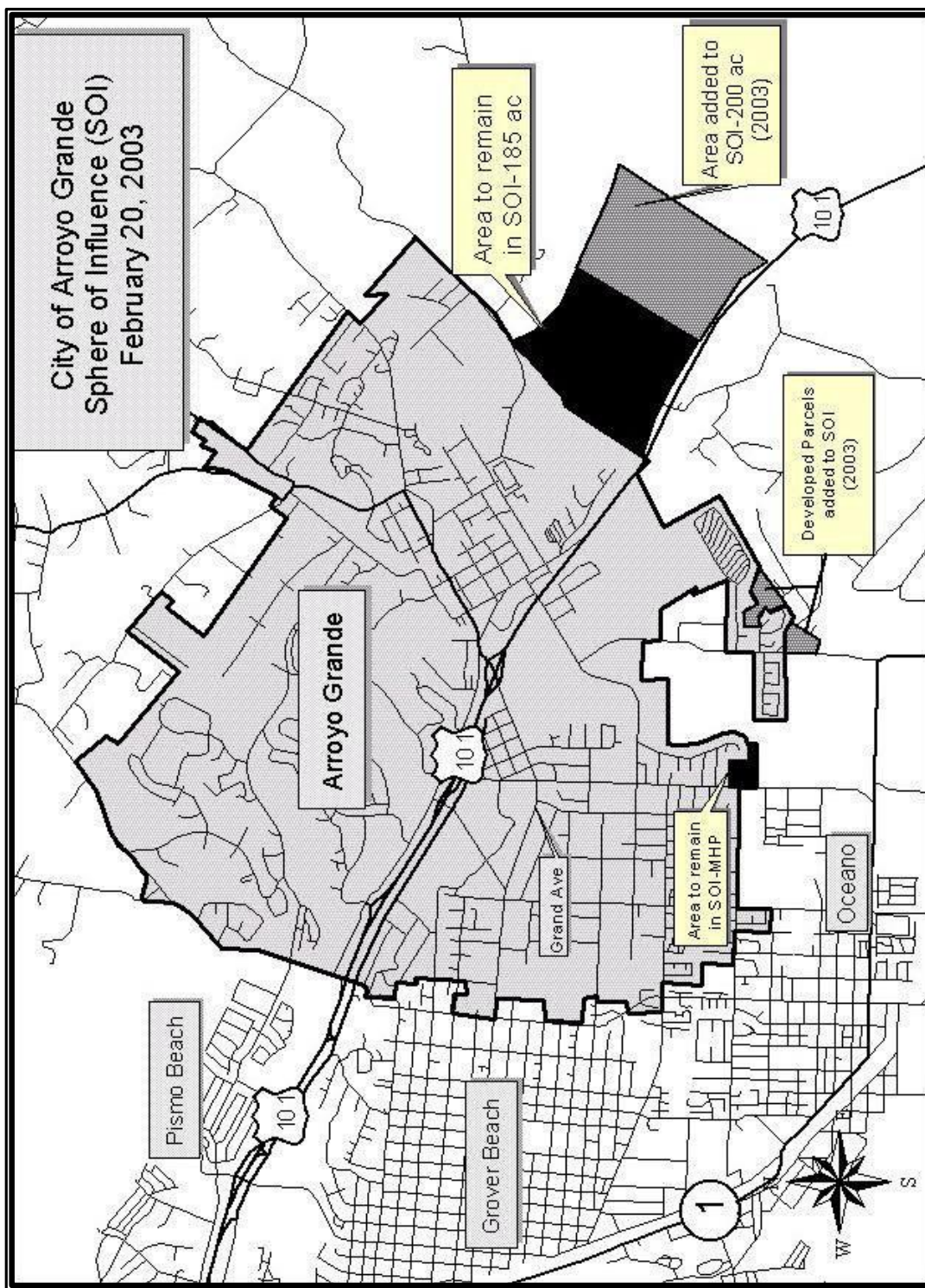

CITY OF GROVER BEACH Sphere of Influence and City Boundary As of January 1, 2005

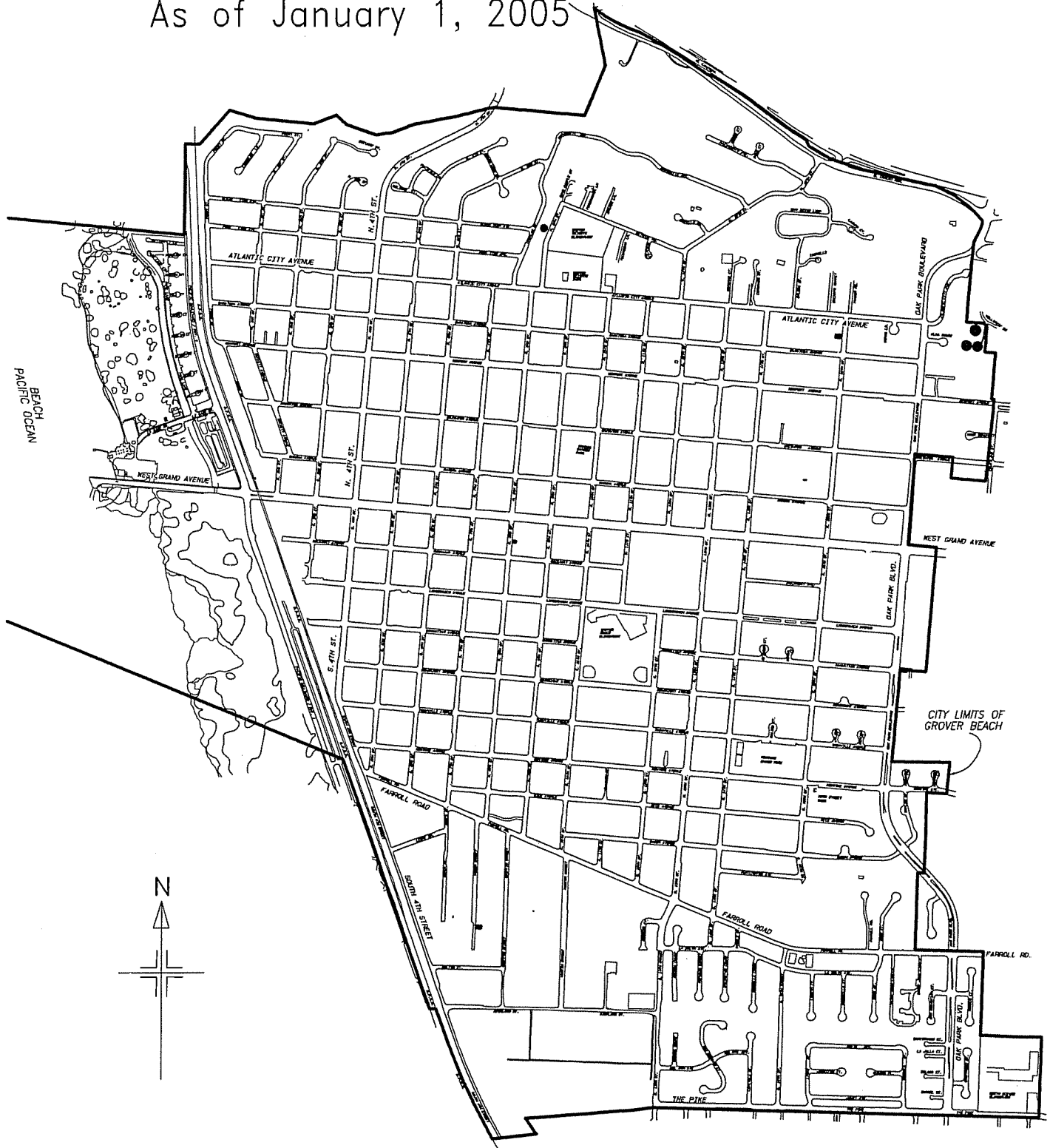

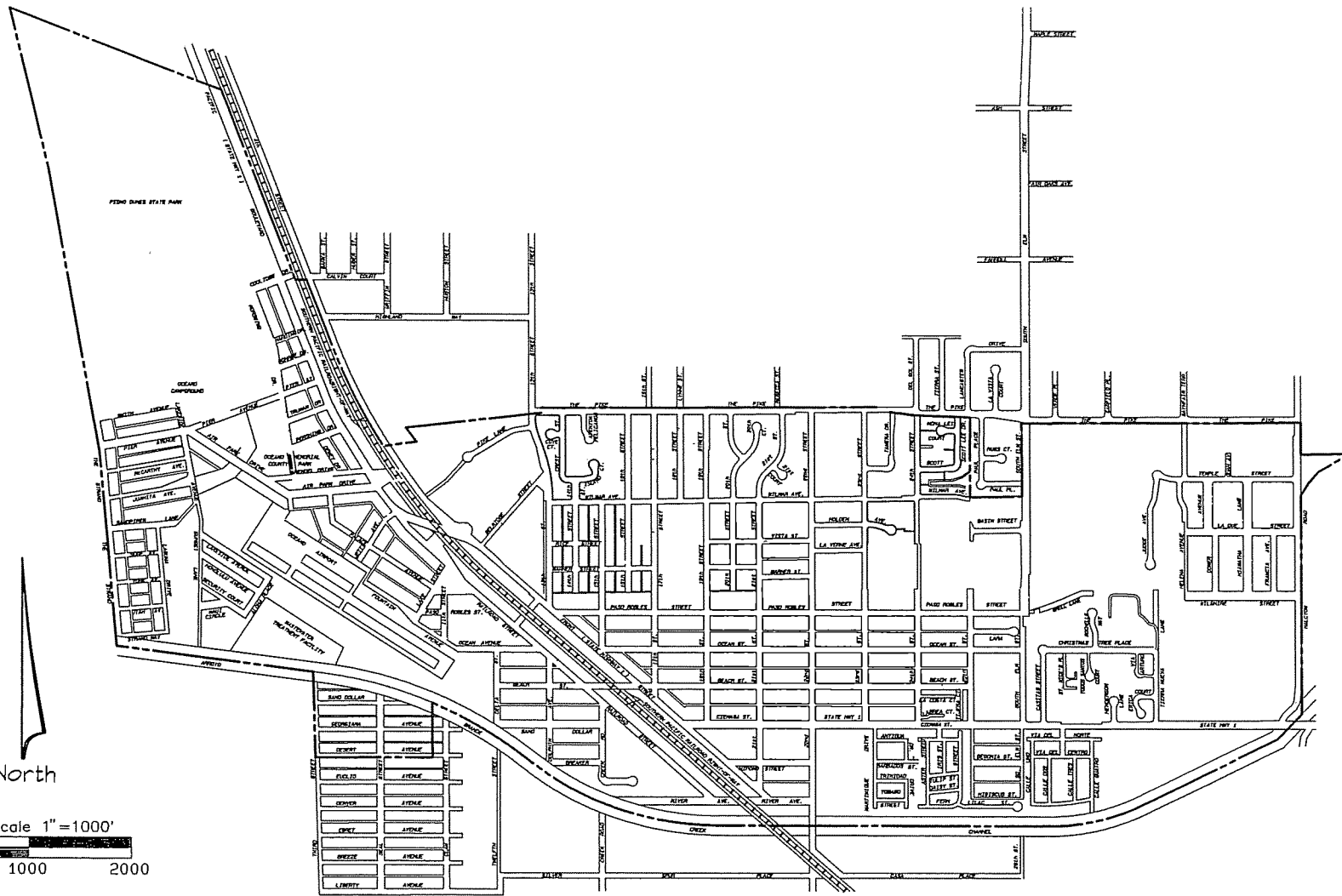
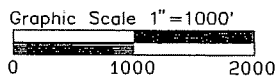

Oceano Community
Services District
P.O. Box 549
1655 Front Street
Oceano, CA 93445-0549
tel (805)481-6730

Service Area and Sphere of Influence January 1, 2005
OCEANO COMMUNITY SERVICES DISTRICT



Civil Engineering
Surveying
Project Development
141 South Elm Street
Arroyo Grande, CA 93420
805/489-1321

Scale: 1" = 1000'
W.O. No. 0D01-007
File Name OCSD_Boundary_and_SOI _01-01-2005.pro
Plot date 6/20/2005

Figure 1 – Existing SOI and Proposed Additions

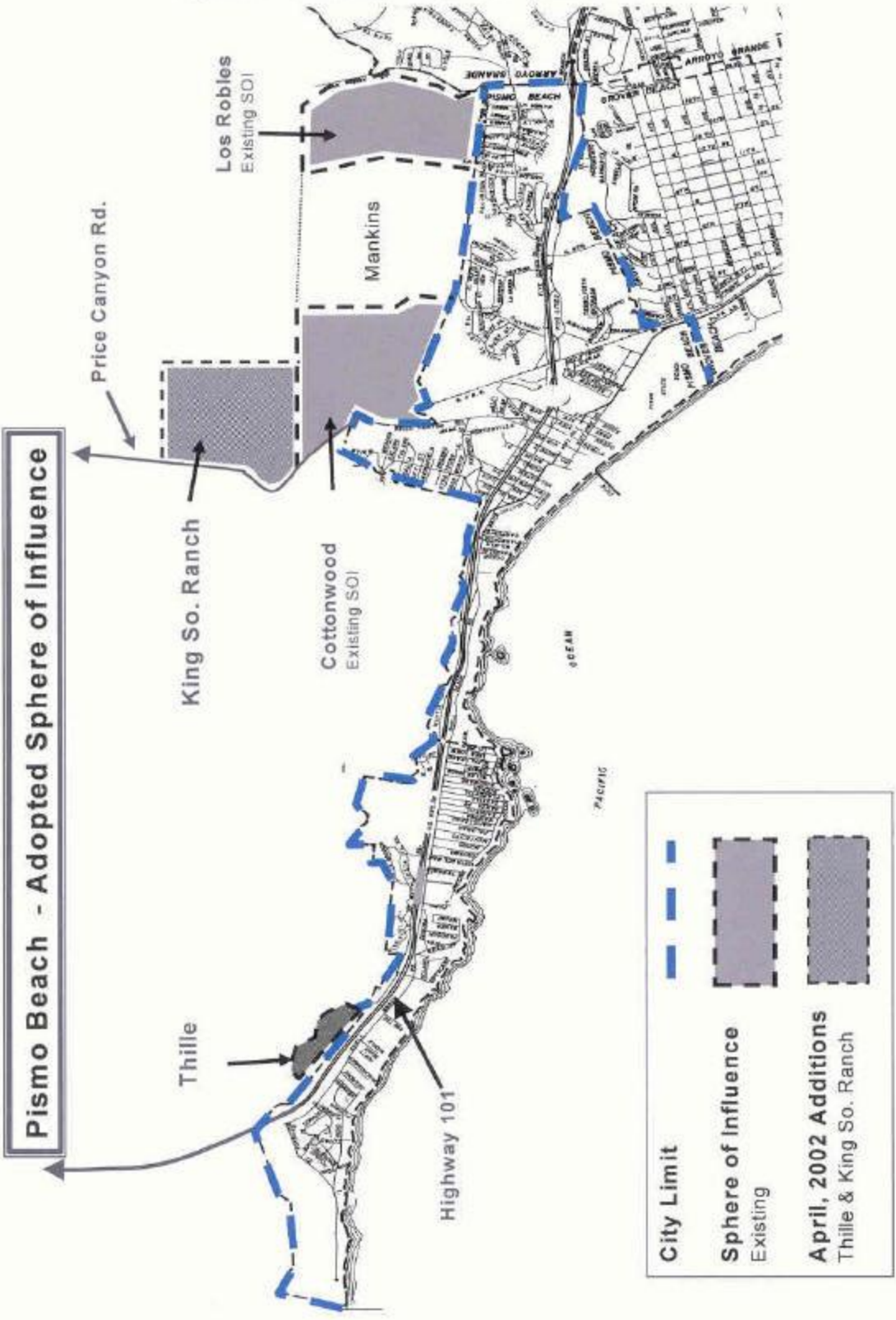

Pismo Beach - Adopted Sphere of Influence

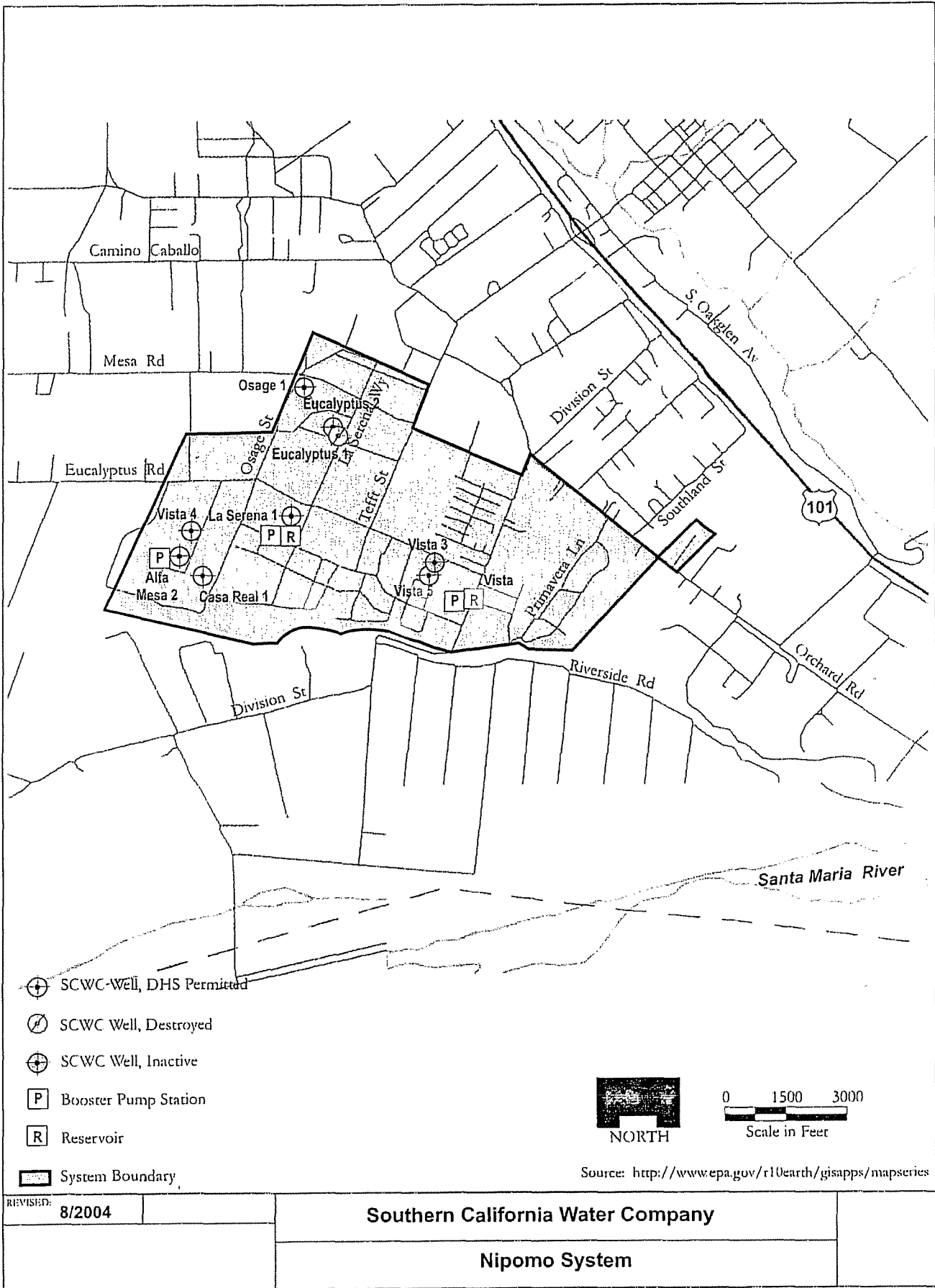

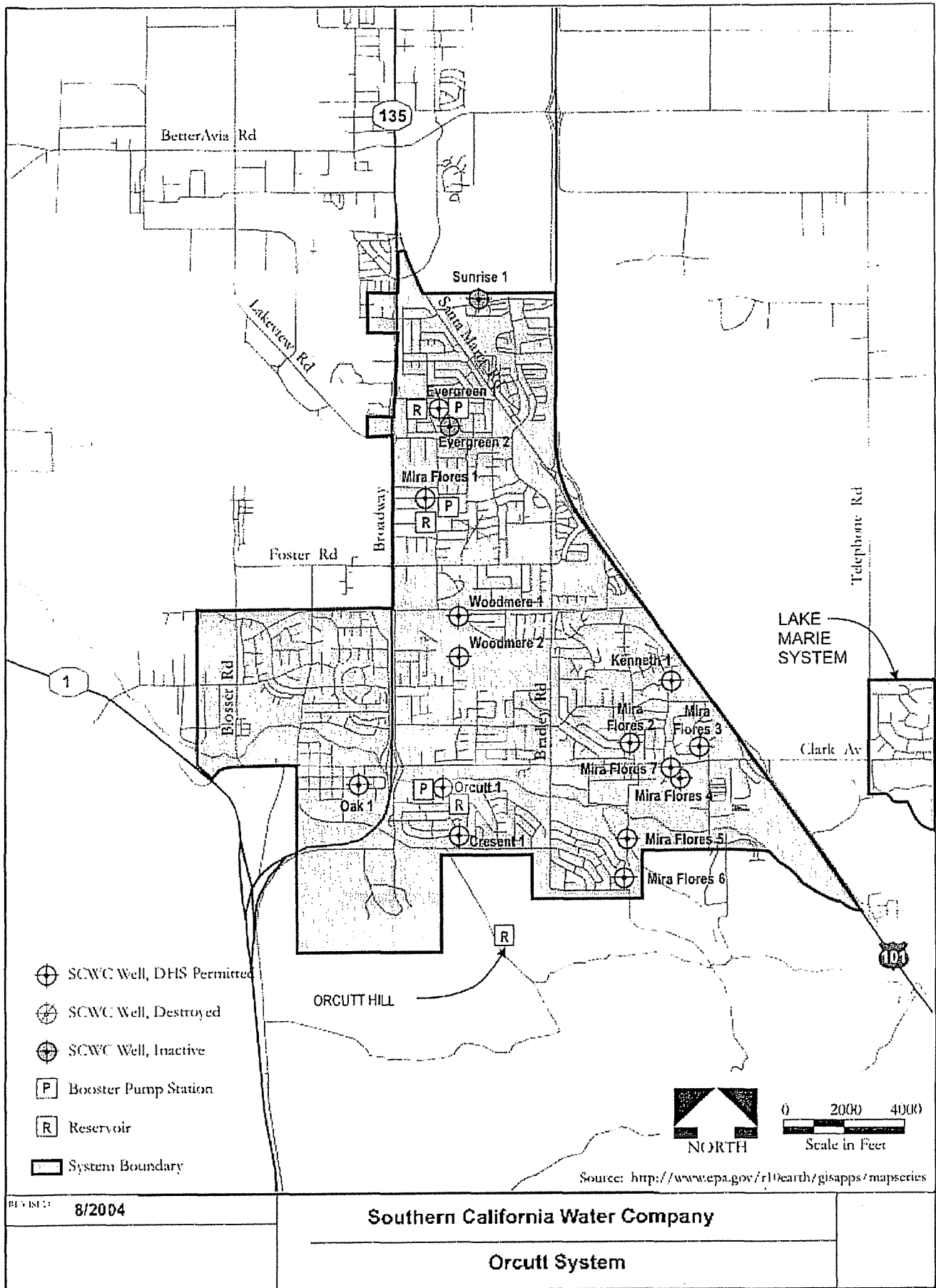

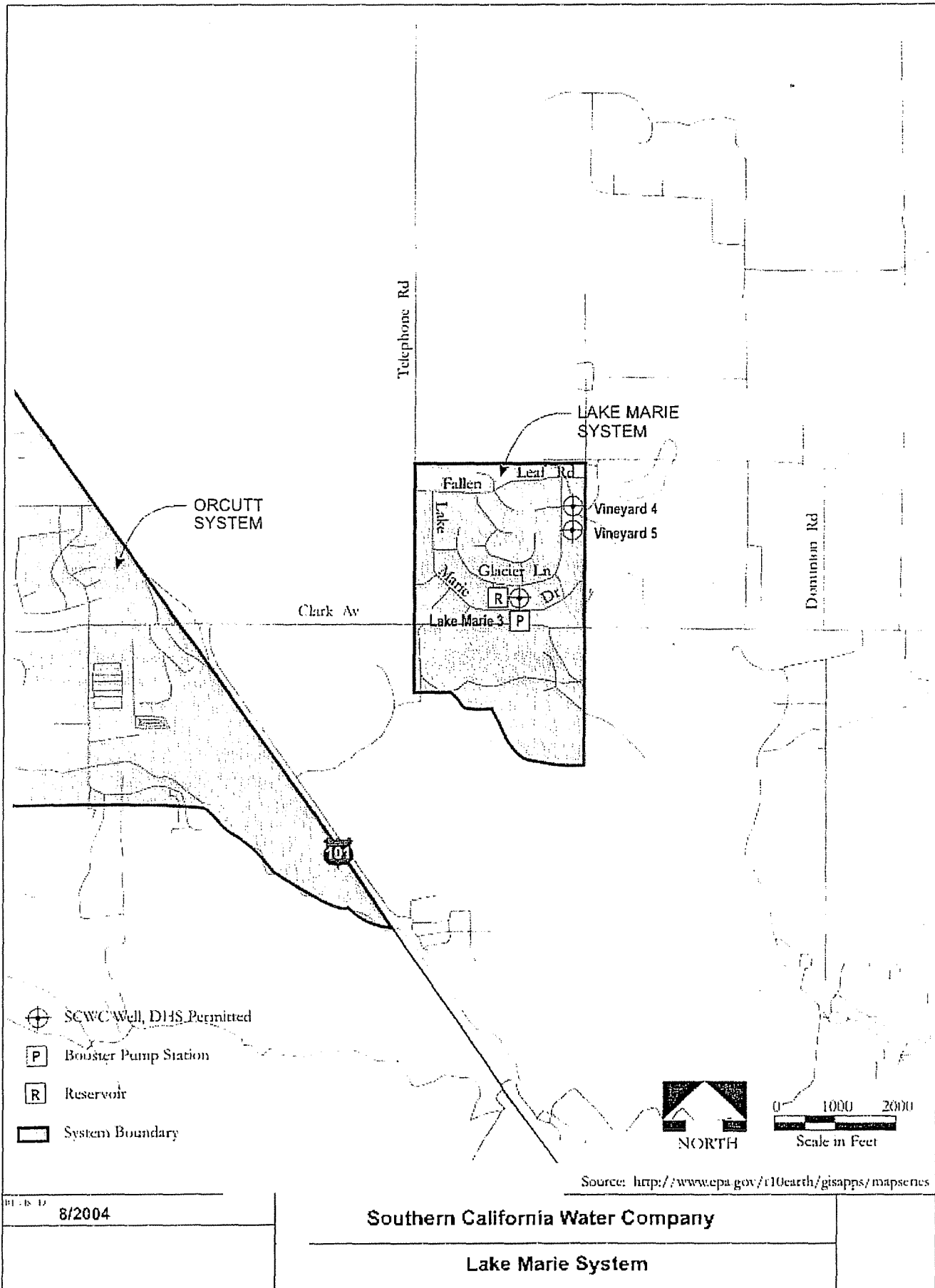

DE-BS-12

8/2004

Southern California Water Company

Lake Marie System

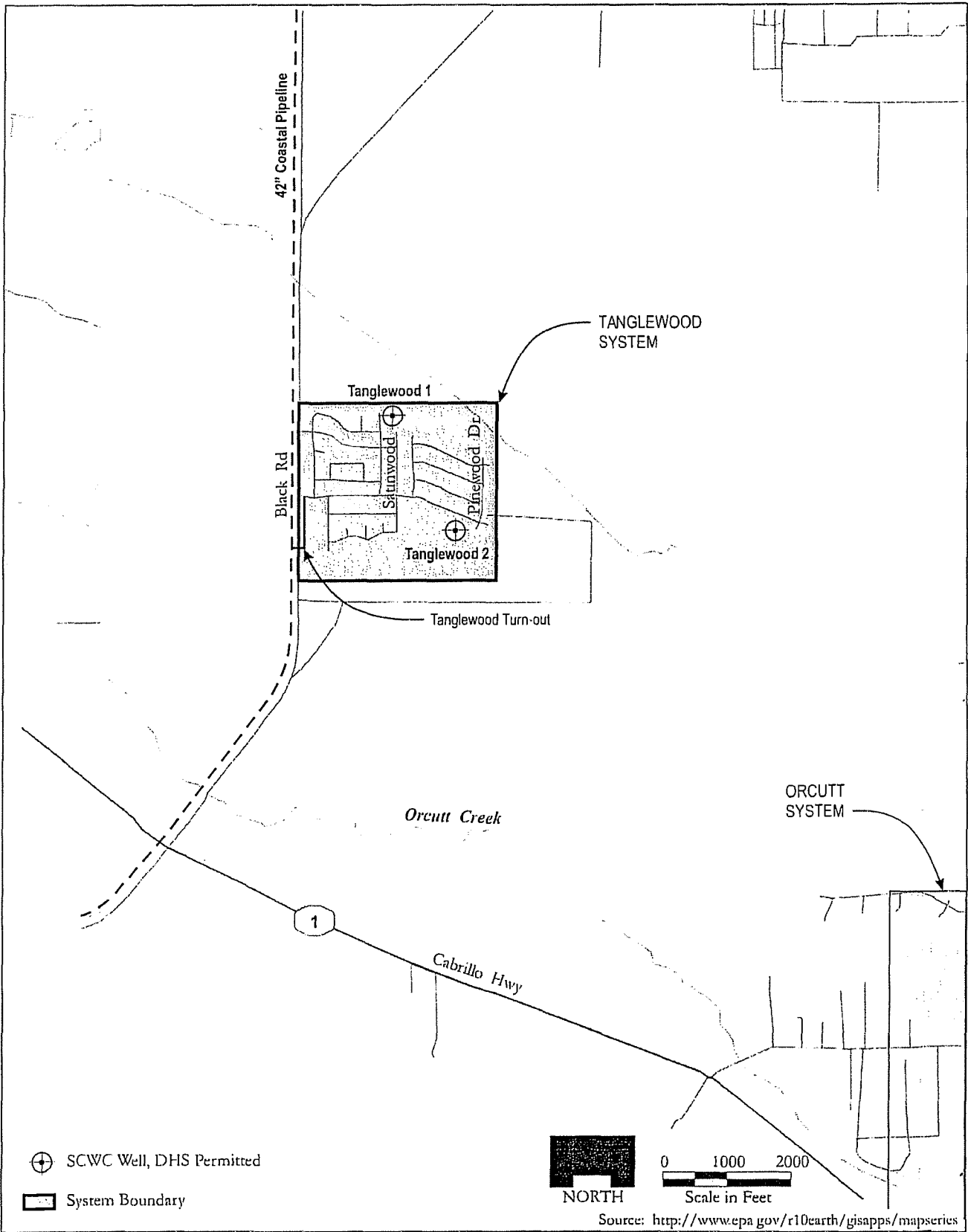

REVISED: 8/2004

Southern California Water Company

Tanglewood System

FIGURE

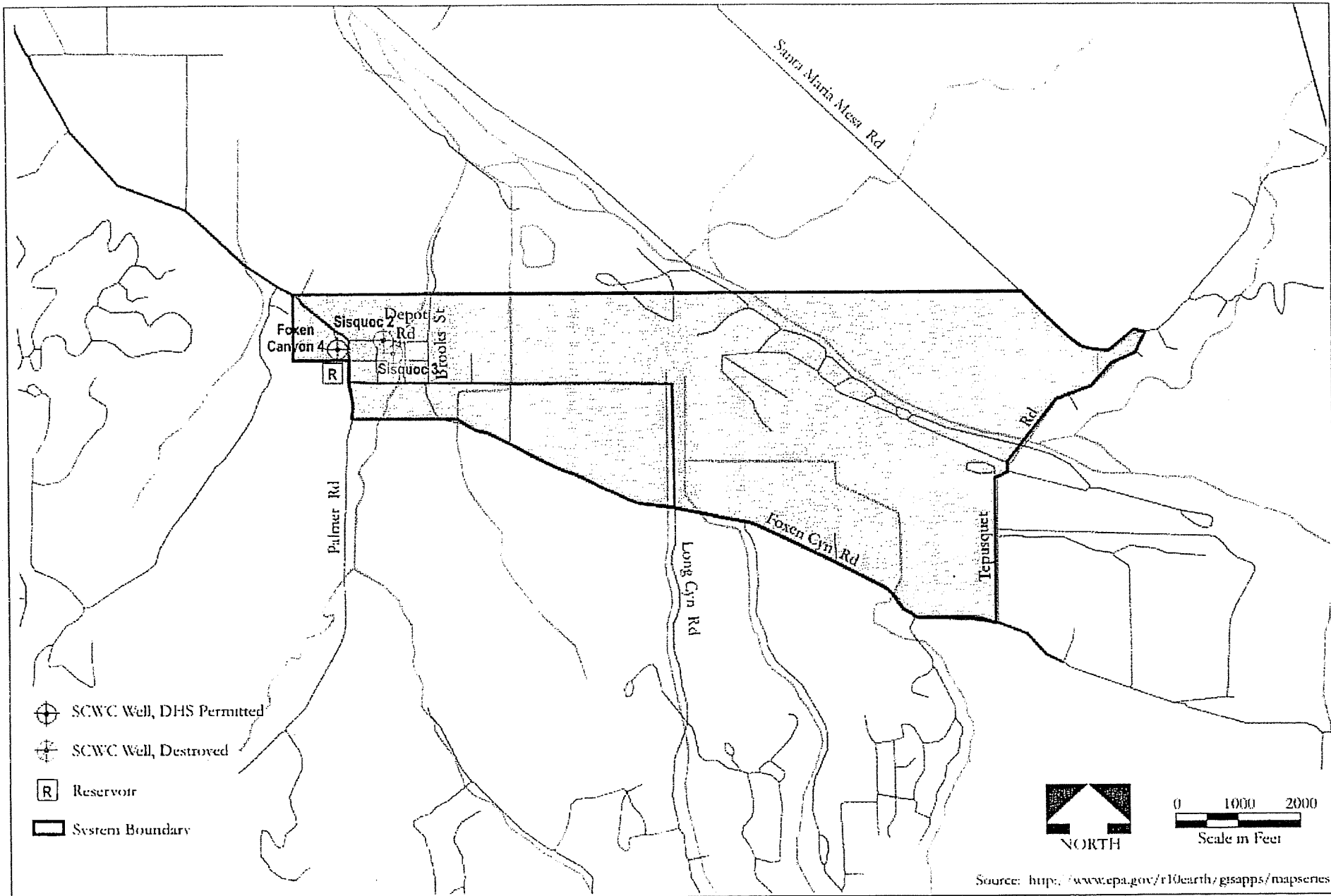

REVISED 8/2004

Southern California Water Company
Sisquoc System

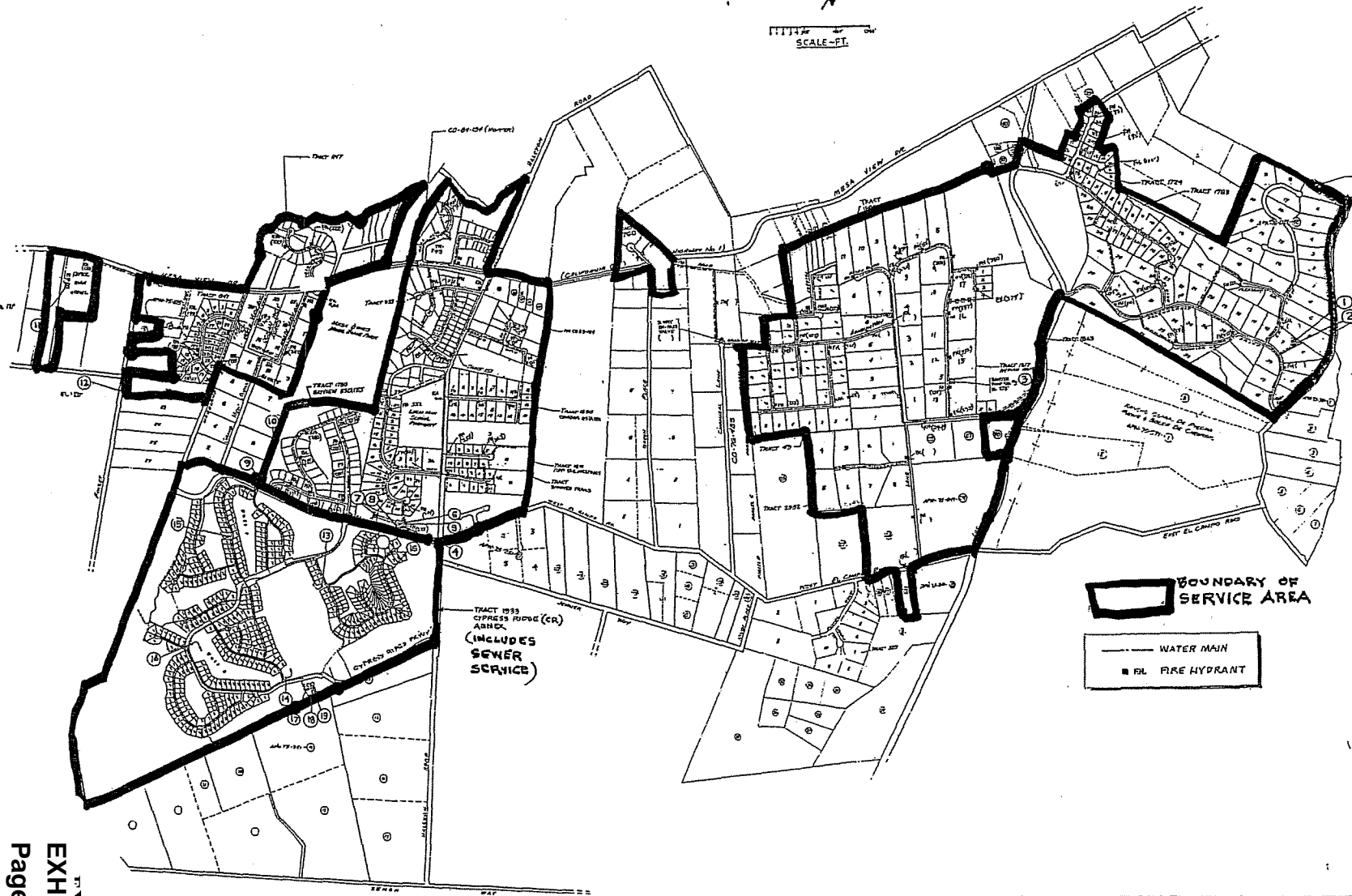
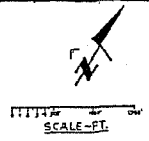

- RURAL WATER COMPANY, INC.**
- ① PUMP STA #2
 - ② STORAGE TANK, 210,000 GAL
 - ③ PUMP STA #3
 - ④ PUMP STA #1, CHLORINATION BLD.
 - ⑤ STORAGE TANK, 245,000 GAL
 - ⑥ STORAGE TANK, 245,000 GAL
 - ⑦ WELL #2
 - ⑧ WELL #6
 - ⑨ WELL #4
 - ⑩ WELL #5
 - ⑪ WELL #8 (WITH CHLORINATION)
 - ⑫ WELL #3 (WITH CHLORINATION)
 - ⑬ CR WELL #4
 - ⑭ CR WELL #5
 - ⑮ CR WELL #6
 - ⑯ CR WELLS #7 & #8 (inactive)
 - ⑰ CR STORAGE TANK, 275,000 GAL
 - ⑱ CR STORAGE TANK, 275,000 GAL
 - ⑲ CR PUMP STA, CHLORINATION BLD.

BOUNDARY OF SERVICE AREA

— WATER MAIN

■ FIRE HYDRANT

APPROVED BY	DATE	APPROVED BY	DATE
RURAL WATER COMP SERVICE AREA MAI			
DESIGNED BY	DATE	APPROVED BY	DATE
CHECKED BY	DATE	APPROVED BY	DATE
SCALE	DATE	APPROVED BY	DATE

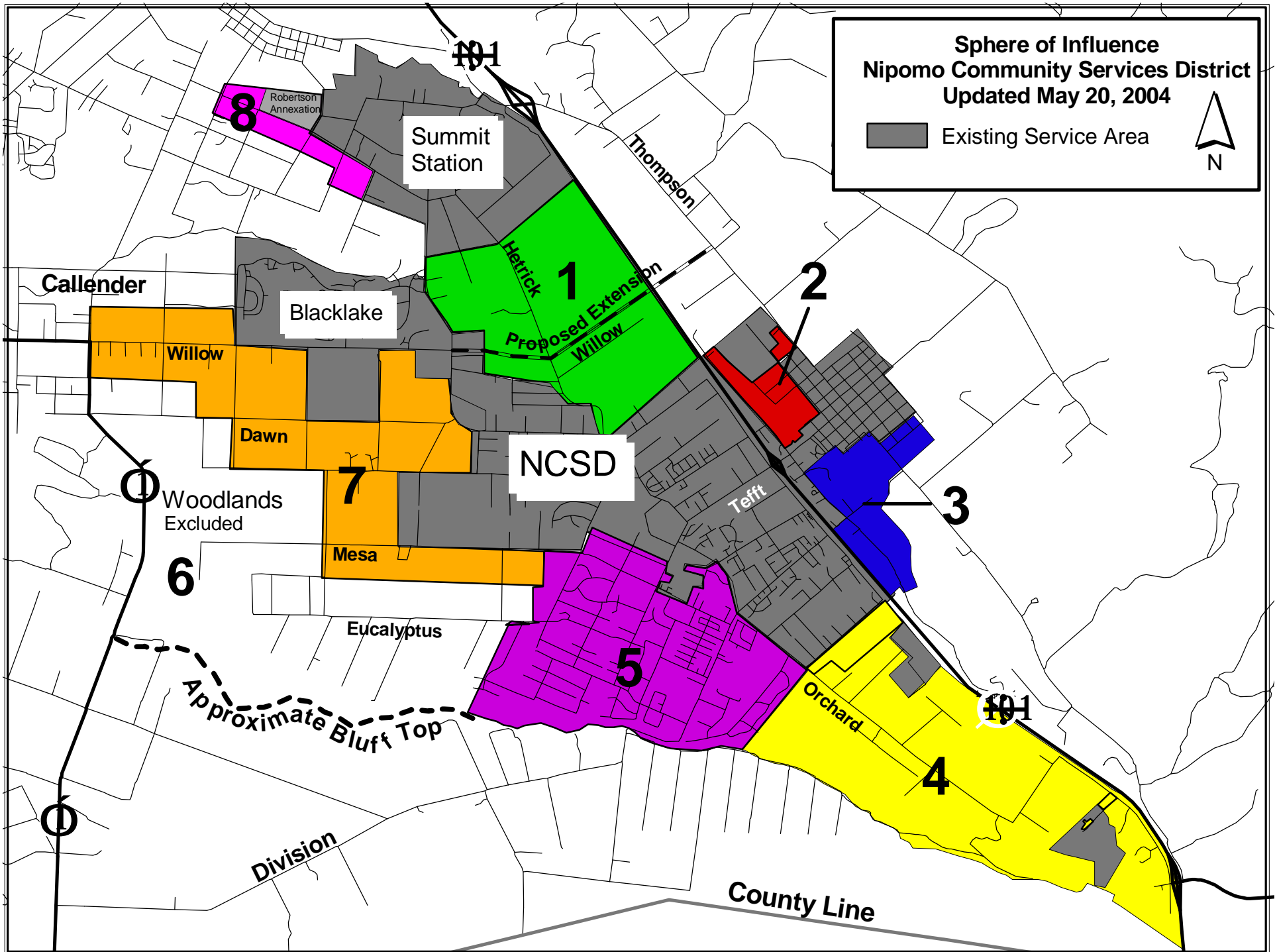

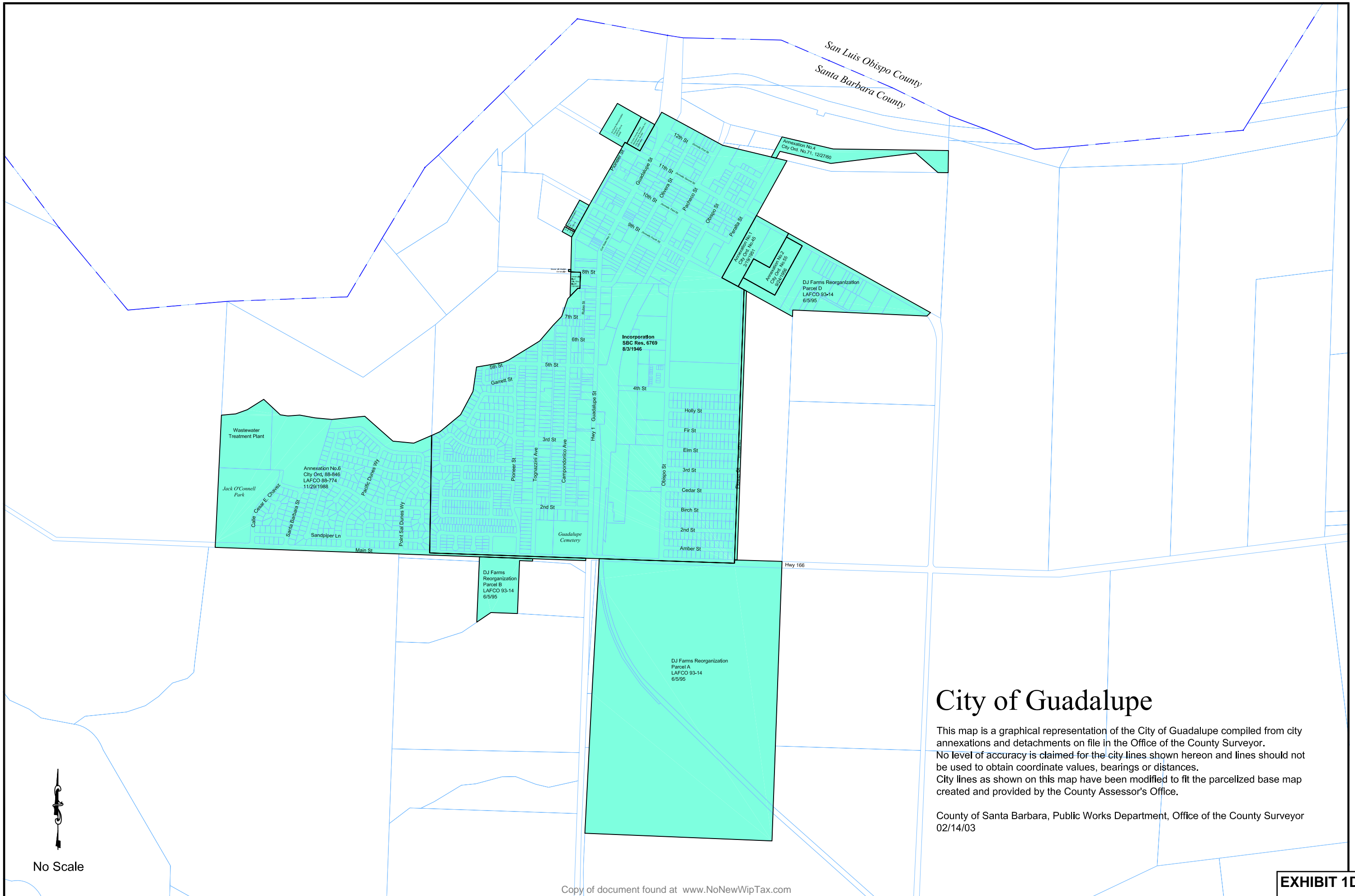

City of Guadalupe

This map is a graphical representation of the City of Guadalupe compiled from city annexations and detachments on file in the Office of the County Surveyor. No level of accuracy is claimed for the city lines shown hereon and lines should not be used to obtain coordinate values, bearings or distances. City lines as shown on this map have been modified to fit the parcelized base map created and provided by the County Assessor's Office.

County of Santa Barbara, Public Works Department, Office of the County Surveyor
02/14/03



Note: This Exhibit has been amended on August 27, 2007 to reflect a parcel change by the County of Santa Barbara, to add parcels that were inadvertently omitted from the original version of Exhibit D that was attached to the June 30, 2005 Stipulation, and to change former APN 128-056-024 to APN 128-064-007.

Stipulation
Santa Maria Valley Water Conservation District v. City of Santa Maria

EXHIBIT 1D

List of Selected Excluded Parcels Nearby the Boundaries of New Urban Use Areas

103-070-004	128-096-010
107-300-007	128-098-005
107-300-008	129-180-020
107-300-012	128-099-001
128-064-007	128-100-001
128-094-018	128-100-003
128-094-019	128-100-020
128-094-020	128-100-021
128-094-021	128-100-022
128-094-023	128-100-027
128-094-024	128-100-028
128-094-029	128-100-029
128-094-031	128-100-030
128-095-001	128-100-031
128-095-002	128-101-010
128-095-003	128-101-012
128-095-004	129-100-008
128-095-006	129-110-020
128-095-008	129-120-001
128-096-001	129-120-023
128-096-002	129-151-029
128-096-003	129-151-031
128-096-004	129-151-032
128-096-005	129-151-033
128-096-006	129-180-010
128-096-007	129-180-011
128-096-009	129-210-017

EXHIBIT 1D
Page 14 of 14